



**THE**  
**Cattlemen's**  
**Cut**

THURSDAY – 1:00 PM CT

**FEBRUARY 22, 2024**

AT THE RANCH – BREWSTER, NEBRASKA

# WELCOME CATTLEMEN

## *the* **Cattlemen's** BREWSTER NEBRASKA **CUT**

Welcome to the 2024 offering from the Cattlemen's Cut Bull Sale! First, we want to thank you for your interest in our sale. This marks our tenth annual sale, and our fourth year of living here in the Sandhills. Time has gone way too fast and as we reflect back on all the years we are overwhelmed with gratitude for the support and trust in our program. As we look back to where we started, to where we are now, we're



almost brought to tears thinking about all the people we've met, the bulls we've raised, and the cows that make our program go. It hasn't come without its share of challenges along the way, but the hope and the dream of passing it all on to the next generation has us so excited for what's to come.

Last May we welcomed our first child, a baby girl named Lainey James. Her name reflects the middle names of our fathers and she has been the absolute light of our lives. We have the opportunity to raise her in the most beautiful place we've ever seen, surrounded by so many of you who have taken us in and called us friends. Her presence has made time stand still and we are so thankful for the journey of parenthood - the beef industry is just one thing we look forward to continuing to share with her.

Making sure we are breeding sound cows to working genetics that will continue to improve our herd, and thrive in the environment is something we're focused on. We want longevity in our herd and we believe the future starts with the female. For this reason we practice strict culling, and performance standards with all our momma cows. From fertility, udders, and docility, we factor it all in to ensure the cows stability in our herd and in yours. We utilize both ET and AI to bring a large offering of both half and full brothers to the sale each year. We love a consistent and balanced cow, that raises a great calf each year, with little intervention. The cows are the building blocks to our herd, and we refuse to chase fads; we continue to rely heavily on the cows that perform, and calves that do the same, with vigor to get them from pasture to rail with minimal inputs. Our main goal is providing animals to your herd and our own that you can trust and rely on - ones that'll pave the way for the next generation.

Our offering again consists of four main sire groups that we have watched and developed closely. We believe in breeding for balanced EPD's, natural muscle, good feet, and sound structure, having faith in knowing the cumulation of these things leads to longevity, and stability. With a high roughage ration, and large amounts of exercise, these bulls are truly bred on, and not fed on, and ready to go to work.

Thank you for your consideration in our offering this year, and for viewing this catalog. Please join us on sale day, February 22nd, for lunch starting at 12p, and the live auction at 1p. The auction will be broadcast on DV Auction the day of the sale, and all cattle are available for viewing anytime prior to the sale. We look forward to talking with you, and seeing you at our home!

*Jason, Katie and Lainey Jagels*

A black and white cow is grazing in a field of white flowers. The cow is in the background, and the flowers are in the foreground. The text "celebrating 10 years!" is overlaid on the image.

*celebrating*  
**10**  
*years!*

# the Cattlemen's CUT

BREWSTER NEBRASKA

THURSDAY – 1:00 PM CT

## FEBRUARY 22, 2024

Jagels Land and Cattle – Brewster, NE  
43500 E North Loup Rd , Brewster NE 68821  
Formerly Spencer Herefords

*Selling* **70 Registered Angus Bulls**

### SALE DAY CONTACTS

Jason Jagels 402-364-3191  
Katie Kaliff-Jagels 402-366-9235  
Mark Jagels 402-469-3373

### AUCTIONEER

Matt Lowery 308-750-6119

### SALE SCHEDULE

8:00 AM – Bulls available for viewing  
12:00 PM – Complimentary Lunch Served  
1:00 PM – The Cattlemens Cut Bull Sale

### REPRESENTATIVES

Will Harsh, Angus Media 740-272-1386  
Chris Beutler, Livestock Digital 402-380-8244  
Randy Rasby, American Cattlemen 308-539-6195  
Scott Beck, The Herd Report 402-649-2562  
Kelvin Jorgensen, Special Assignment 402-366-9475

### VOLUME DISCOUNTS

2.5% DISCOUNT ON 2-5 BULLS  
5% DISCOUNT ON 5 OR MORE BULLS

### DELIVERY

The Cattlemen's Cut offers free delivery to Nebraska and adjoining states. After the sale, bulls will be freeze branded, semen tested, and delivery will start March 1.

### LIABILITY

The Cattlemens Cut does not assume any liability in case of accident or loss of property.

### ANNOUNCEMENTS

If there is any inconsistency in the terms of any sales materials, including sale books, supplement sheets or day-of-sale announcements, (i) the day-of sale announcement will control over both the supplement sheet and the sale book, and (ii) the supplement sheet will control over the sale book.

### HERD HEALTH

CALVING – Inforce 3, Multimin 90, Calf Guard  
EARLY PROCESSING (about 3 months)  
Pyramid 5 + Presponse SQ, Ultrabac 7. Clostridium  
WEANING (about 7 months)  
Pyramid 5, Ultrabac 7, Cydectin, Safeguard  
YEARLING (about 1 year) – Virashield 6 VL5, Vision 7, Cydectin Pour on, Safe Guard Dewormer, Multimin 90

### THE CATTLEMENS CUT GUARANTEE

All bulls sell backed by The Cattlemens Cut Guarantee. They are guaranteed throughout the first breeding season or 90 days post turn out against injury or death. The animal becomes the property of the purchaser as soon as sold, but it shall be the responsibility of the seller to see that animals are properly cared for until delivered to the purchaser. Purchase price minus \$1,750 salvage value will be given with a replacement animal of equal value to the animal in question or credit will be issued at the next annual sale. A veterinarian must diagnose all injured bulls.



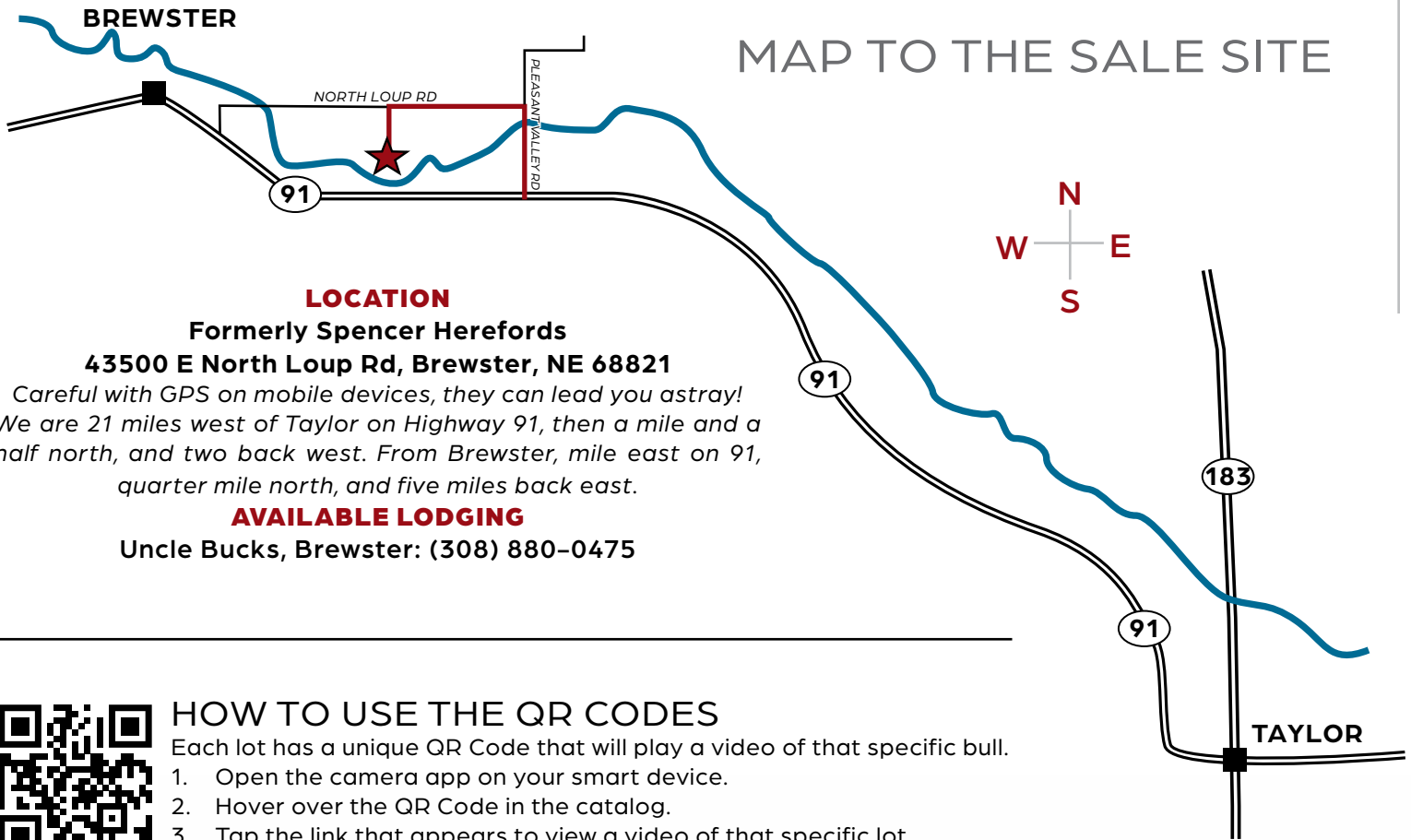

## MAP TO THE SALE SITE

### LOCATION

Formerly Spencer Herefords

43500 E North Loup Rd, Brewster, NE 68821

Careful with GPS on mobile devices, they can lead you astray!  
 We are 21 miles west of Taylor on Highway 91, then a mile and a half north, and two back west. From Brewster, mile east on 91, quarter mile north, and five miles back east.

### AVAILABLE LODGING

Uncle Bucks, Brewster: (308) 880-0475



### HOW TO USE THE QR CODES

Each lot has a unique QR Code that will play a video of that specific bull.

1. Open the camera app on your smart device.
2. Hover over the QR Code in the catalog.
3. Tap the link that appears to view a video of that specific lot.

*Please note that videos will not be available until two weeks prior to the sale.*

**DVAuction**  
*Broadcasting Real-Time Auctions*

### WATCH AND BID LIVE

The sale will be broadcast live on DV Auction. Please sign up to bid 24 hours before the sale!

*celebrating*  
**10**  
*years!*



# feature lots

## LOT 1 CATTLEMENS CUT SALE



**J REVERED 3022**

### 1 J Reversed 3022

REG: 20764453 DOB: 01/11/23 TATTOO: 3022



Basin Rainmaker 4404  
**LT Reversed**  
 LT Ashley 7078  
 T/D Midwest 8330  
**J Joanie 1124**  
 Mill Brae Ident Joanie 4024

Basin Rainmaker 2704  
 Basin Joy 1036  
 S Foundation 514  
 LT Ashley 8263  
 B/R Nationwide 69  
 B/R Ruby of Tiffany 3210  
 Koupals B&B Identity  
 Mill Brae IF Joanie 2086

**ACT BW**  
77  
**ADJ WW RATIO**  
868 / 121  
**ADJ YW RATIO**  
1414 / 112



CED	BW	WW	YW	SC	DOC	MILK	DAM BR										
11	0.3	76	137	1.19	27	27	1@97										
CW	MARB	RE	\$M	\$W	\$B	\$C	DAM WR										
74	0.67	0.64	76	72	176	304	1@121										
CED	BW	WW	YW	DMI	YH	SC	DOC	HP	CEM	MLK	MW	MH	CW	MRB	RE	FAT	TEND
37	38	15	14	67	17	28	15	18	17	61	35	21	7	52	50	76	32

- **Dam's Calving Interval:** First Calf Heifer
- **Recommended for heifers or cows.**

Excellent herd sire prospect that is big framed than most calving ease sires with added shape and dimension. Traces back to a cornerstone donor. First calf dam off to a great start.

# feature lots

## LOT 2 CATTLEMENS CUT SALE



**J TRADEMARK 3095**

### 2 J Trademark 3095

REG: 20761848 DOB: 01/23/23 TATTOO: 3095



**J Trademark 1037**  
 | Sitz Resilient 10208  
 | Mill Brae Iden Georgina 4086  
 | Casino Bomber N33  
**J Blackcap 0102 ET**  
 | Mill Brae Obj Blackcap 9244

Sitz Stellar 726D  
 Sitz Miss Burgess 1856  
 Koupals B&B Identity  
 Mill Brae FA Georgina 0237  
 KM Broken Bow 002  
 Casino Annie K48  
 S S Objective T510 0T26  
 Mill Brae RT Blackcap 8022

**ACT BW**

81

**ADJ WW RATIO**

807 / 112

**ADJ YW RATIO**

1381 / 109



CED	BW	WW	YW	SC	DOC	MILK	DAM BR										
13	-1.2	85	152	0.47	27	41	2@101										
CW	MARB	RE	\$M	\$W	\$B	\$C	DAM WR										
84	0.83	0.68	76	92	193	326	2@104										
CED	BW	WW	YW	DMI	YH	SC	DOC	HP	CEM	MLK	MW	MH	CW	MRB	RE	FAT	TEND
5	19	5	4	92	20	51	8	14	73	4	13	23	1	35	12	33	14

- Dam's Calving Interval: 349 days
- Recommended for heifers or cows.

Excellent spread bull to lead off the first crop of Trademarks. Donors on both sides of the pedigree this bull is long and fluid in his build with production and end product merit.

# feature lots

## LOT 3 CATTLEMENS CUT SALE



**J FAIR-N-SQUARE 3013**

### 3 J Fair-N-Square 3013

REG: 20763187 DOB: 01/09/23 TATTOO: 3013



Woodhill Blueprint  
**Myers Fair-N-Square M39**  
 Myers Miss Beauty M136  
 T/D Midwest 8330  
**J Ellunamere 1173**  
 Poss Ellunamere 5507

Connealy Confidence Plus  
 Woodhill Evergreen Z291-B233  
 Connealy Thunder  
 Myers Miss Beauty M476  
 B/R Nationwide 69  
 B/R Ruby of Tiffany 3210  
 Poss Easy Impact 0119  
 Poss Ellunamere 119

**ACT BW**

85

**ADJ WW RATIO**

816 / 113

**ADJ YW RATIO**

1368 / 108



CED	BW	WW	YW	SC	DOC	MILK	DAM BR										
5	2.7	89	154	0.64	24	16	1@106										
CW	MARB	RE	\$M	\$W	\$B	\$C	DAM WR										
67	0.67	0.77	47	64	160	255	1@113										
CED	BW	WW	YW	DMI	YH	SC	DOC	HP	CEM	MLK	MW	MH	CW	MRB	RE	FAT	TEND
41	53	8	19	88	60	47	31	36	89	95	4	28	19	43	31	90	59

- **Dam's Calving Interval:** First Calf Heifer
- **Recommended for cows.**

The Fair n Squares have been a favorite for us and this bull is no exception. Long sided, big middled, and full of red meat. Excellent prospect out of a first calf heifer.



# feature lots

## LOT 4 CATTLEMENS CUT SALE



**J PANHANDLE 3040**

### 4 J Panhandle 3040

REG: 20789783 DOB: 01/13/23 TATTOO: 3040



Marcys 17 Scale Crusher 34-7  
 Marcys Panhandle 214-9  
 Marcys 12 Ethelda E 64-2  
 KM Broken Bow 002  
 J Gmar 9085  
 Gmar Resource D160

Marcys Scale Crusher  
 Marcys 13 Ethelda E 4-3  
 Connealy Consensus 7229  
 Marcys 10 Ethelda E 165-0  
 Summitcrest Complete 1P55  
 Summitcrest Princess 0P12  
 S A V Resource 1441  
 Gmar Alliance U096

**ACT BW**

91

**ADJ WW RATIO**

744 / 103

**ADJ YW RATIO**

1354 / 105



CED	BW	WW	YW	SC	DOC	MILK	DAM BR										
-1	3.6	72	129	0.46	14	43	3@97										
CW	MARB	RE	\$M	\$W	\$B	\$C	DAM WR										
64	0.60	0.65	67	73	150	262	3@100										
CED	BW	WW	YW	DMI	YH	SC	DOC	HP	CEM	MLK	MW	MH	CW	MRB	RE	FAT	TEND
71	52	13	16	95	19	66	74	41	24	1	28	23	8	28	32	88	62

- Dam's Calving Interval: 364 days
- Recommended for cows.

Hard to fault the muscle shape and pattern in this Panhandle calf. Long sided, extremely stout made and stands wide and square at the ground. Dam earning her stripes the old fashioned way.

# Trademark sons

reference sire

## J Trademark 1037 20160403

Sitz Resilient 10208 X Mill Brae Iden Georgina 4086

by Koupals B&B Identity

CED	BW	WW	YW	SC	DOC	MILK
8	0.5	74	132	0.41	22	29
CW	MARB	RE	\$M	\$W	\$B	\$C
61	0.63	0.62	94	76	159	300



### LOT 5 CATTLEMENS CUT SALE



J TRADEMARK 3121

## 5 J Trademark 3121

REG: 20761840 DOB: 01/26/23 TATTOO: 3121



J Trademark 1037  
Sitz Resilient 10208  
Sitz Miss Burgess 1856  
Koupals B&B Identity  
Mill Brae FA Georgina 4086  
Mill Brae FA Georgina 0237  
T/D Midwest 8330  
B/R Nationwide 69  
J Elba 1043  
B/R Ruby of Tiffany 3210  
J Elba 6004  
Musgrave Big Sky  
R T P Bismarck Elba 12

ACT BW  
77  
ADJ WW RATIO  
802 / 111  
ADJ YW RATIO  
1368 / 108

CED	BW	WW	YW	SC	DOC	MILK	DAM BR										
11	-0.1	84	149	0.75	26	32	1@97										
CW	MARB	RE	\$M	\$W	\$B	\$C	DAM WR										
60	0.91	0.56	91	87	158	296	1@111										
CED	BW	WW	YW	DMI	YH	SC	DOC	HP	CEM	MLK	MW	MH	CW	MRB	RE	FAT	TEND
51	67	2	4	99	44	61	10	40	36	15	28	47	7	11	29	74	20

- Dam's Calving Interval: First Calf Heifer
- Recommended for heifers or cows. Calving ease bull with extra shape and dimension. Great cow family.

flush brothers LOTS 6-7

Excellent set of flush brothers out of a bulletproof Plus donor. Heifer bulls with frame and growth.

## 6 J Trademark 3192 ET

REG: 20769220 DOB: 02/05/23 TATTOO: 3192



J Trademark 1037  
Sitz Resilient 10208  
Sitz Miss Burgess 1856  
Koupals B&B Identity  
Mill Brae Iden Georgina 4086  
Mill Brae FA Georgina 0237  
Connealy Confidence Plus  
Connealy Confidence 0100  
Mill Brae CP Eileen 8032  
Elbanna of Conanga 1209  
Koupals B&B Identity  
Mill Brae Ident Eileen 6069  
Mill Brae FP Eileen 4107

CED	BW	WW	YW	SC	DOC	MILK	DAM BR										
12	-1.2	77	145	0.25	26	22	3@88										
CW	MARB	RE	\$M	\$W	\$B	\$C	DAM WR										
71	1.20	0.83	92	74	203	355	3@99										
CED	BW	WW	YW	DMI	YH	SC	DOC	HP	CEM	MLK	MW	MH	CW	MRB	RE	FAT	TEND
18	28	32	8	83	89	89	27	54	81	95	73	87	12	3	32	81	61

- Dam's Calving Interval: 379 days
- Recommended for heifers or cows.

## 7 J Trademark 3190 ET

REG: 20769225 DOB: 02/05/23 TATTOO: 3190



J Trademark 1037  
Sitz Resilient 10208  
Sitz Miss Burgess 1856  
Koupals B&B Identity  
Mill Brae Iden Georgina 4086  
Mill Brae FA Georgina 0237  
Connealy Confidence Plus  
Connealy Confidence 0100  
Mill Brae CP Eileen 8032  
Elbanna of Conanga 1209  
Koupals B&B Identity  
Mill Brae Ident Eileen 6069  
Mill Brae FP Eileen 4107

CED	BW	WW	YW	SC	DOC	MILK	DAM BR										
13	-0.3	77	146	-0.38	20	29	3@88										
CW	MARB	RE	\$M	\$W	\$B	\$C	DAM WR										
74	0.65	1.10	84	77	186	325	3@99										
CED	BW	WW	YW	DMI	YH	SC	DOC	HP	CEM	MLK	MW	MH	CW	MRB	RE	FAT	TEND
4	10	24	9	83	15	95	49	26	30	28	54	28	5	48	5	57	6

- Dam's Calving Interval: 379 days
- Recommended for heifers or cows.

# 8 J Trademark 3053

REG: 20769232 DOB: 01/16/23 TATTOO: 3053



Sitz Resilient 10208  
**J Trademark 1037**  
 Mill Brae Iden Georgina 4086  
 Mill Brae Endurance 2118  
**Mill Brae Endur Eulima 6140**  
 Mill Brae HD Eulima 4045

Sitz Stellar 726D  
 Sitz Miss Burgess 1856  
 Koupals B&B Identity  
 Mill Brae FA Georgina 0237  
 Sitz Dash 10277  
 Mill Brae FA Queen 8035  
 Hoover Dam  
 Mill Brae Bis Eulima 2048

<b>ACT BW</b>	81
<b>ADJ WW RATIO</b>	827 / 115
<b>ADJ YW RATIO</b>	1357 / 106
<b>DAM BR</b>	5@92
<b>DAM WR</b>	5@106

CED	BW	WW	YW	SC	DOC	MILK	DAM BR										
11	-0.4	77	132	0.63	7	30	5@92										
CW	MARB	RE	\$M	\$W	\$B	\$C	DAM WR										
50	-0.05	0.75	76	80	97	202	5@106										
CED	BW	WW	YW	DMI	YH	SC	DOC	HP	CEM	MLK	MW	MH	CW	MRB	RE	FAT	TEND
43	46	4	11	99	7	68	92	20	28	9	22	10	12	96	15	74	46

- **Dam's Calving Interval:** 368 days
- **Recommended for heifers or cows.** Larger framed spread bull out of a no miss cow headed to the donor pen.

## LOT 8 CATTLEMENS CUT SALE



J TRADEMARK 3053

Lot 9 & 10 are full brothers in blood back to our 9244 donor. Heifer bulls with added length and frame to not sacrifice pounds or maternal merit.

# 9 J Trademark 3084

REG: 20761852 DOB: 01/21/23 TATTOO: 3084



Sitz Resilient 10208  
**J Trademark 1037**  
 Mill Brae Iden Georgina 4086  
 Casino Bomber N33  
**J Blackcap 0107 ET**  
 Mill Brae Obj Blackcap 9244

Sitz Stellar 726D  
 Sitz Miss Burgess 1856  
 Koupals B&B Identity  
 Mill Brae FA Georgina 0237  
 KM Broken Bow 002  
 Casino Annie K48  
 S S Objective T510 OT26  
 Mill Brae RT Blackcap 8022

<b>ACT BW</b>	84
<b>ADJ WW RATIO</b>	773 / 107
<b>ADJ YW RATIO</b>	1339 / 106
<b>DAM BR</b>	2@98
<b>DAM WR</b>	2@103

CED	BW	WW	YW	SC	DOC	MILK	DAM BR										
9	-0.7	85	145	1.39	22	32	2@98										
CW	MARB	RE	\$M	\$W	\$B	\$C	DAM WR										
74	0.87	0.68	85	89	183	322	2@103										
CED	BW	WW	YW	DMI	YH	SC	DOC	HP	CEM	MLK	MW	MH	CW	MRB	RE	FAT	TEND
18	19	4	10	82	6	8	20	23	26	9	26	12	2	27	9	9	18

- **Dam's Calving Interval:** 338 days
- **Recommended for heifers or cows.**



Granddam to Lots 9-10 Mill Brae Obj Blackcap 9244

# 10 J Trademark 3109

REG: 20761855 DOB: 01/25/23 TATTOO: 3109



Sitz Resilient 10208  
**J Trademark 1037**  
 Mill Brae Iden Georgina 4086  
 Casino Bomber N33  
**J Blackcap 0119 ET**  
 Mill Brae Obj Blackcap 9244

Sitz Stellar 726D  
 Sitz Miss Burgess 1856  
 Koupals B&B Identity  
 Mill Brae FA Georgina 0237  
 KM Broken Bow 002  
 Casino Annie K48  
 S S Objective T510 OT26  
 Mill Brae RT Blackcap 8022

<b>ACT BW</b>	79
<b>ADJ WW RATIO</b>	813 / 113
<b>ADJ YW RATIO</b>	1387 / 108
<b>DAM BR</b>	2@97
<b>DAM WR</b>	2@115

CED	BW	WW	YW	SC	DOC	MILK	DAM BR										
11	-0.1	91	154	1.16	17	28	2@97										
CW	MARB	RE	\$M	\$W	\$B	\$C	DAM WR										
79	1.22	0.78	85	91	194	337	2@115										
CED	BW	WW	YW	DMI	YH	SC	DOC	HP	CEM	MLK	MW	MH	CW	MRB	RE	FAT	TEND
12	24	10	15	97	32	15	62	53	33	51	44	57	5	7	22	73	5

- **Dam's Calving Interval:** 350 days
- **Recommended for heifers or cows.**



Thank you to all who helped at our 2023 branding!

# 11 J Trademark 3145

REG: 20769233 DOB: 01/28/23 TATTOO: 3145



Sitz Resilient 10208  
**J Trademark 1037**  
 Mill Brae Iden Georgina 4086  
 Musgrave Big Sky  
**J Elba 6004**  
 R T P Bismarck Elba 12

Sitz Stellar 726D  
 Sitz Miss Burgess 1856  
 Koupals B&B Identity  
 Mill Brae FA Georgina 0237  
 Connealy Earnan 076E  
 SAV Primrose 7861  
 S A V Bismarck 5682  
 Sik Elba Rose 141605

**ACT BW**  
95  
**ADJ WW RATIO**  
742 / 103  
**ADJ YW RATIO**  
1299 / 103

CED	BW	WW	YW	SC	DOC	MILK	DAM BR										
7	3.5	81	133	0.16	17	20	6@109										
CW	MARB	RE	\$M	\$W	\$B	\$C	DAM WR										
56	0.47	0.76	78	68	148	270	6@103										
CED	BW	WW	YW	DMI	YH	SC	DOC	HP	CEM	MLK	MW	MH	CW	MRB	RE	FAT	TEND
81	98	1	11	71	7	86	60	63	23	78	13	9	6	59	10	13	67

- **Dam's Calving Interval:** 369 days
- **Recommended for cows.** The Big Sky daughters have been great to us. Excellent calf, his ears are not heritable.

# 12 J Trademark 3067

REG: 20769231 DOB: 01/18/23 TATTOO: 3067



Sitz Resilient 10208  
**J Trademark 1037**  
 Mill Brae Iden Georgina 4086  
 Mill Brae Endurance 2118  
**Mill Brae Endur Karama 6208**  
 Mill Brae IM Karama 1153

Sitz Stellar 726D  
 Sitz Miss Burgess 1856  
 Koupals B&B Identity  
 Mill Brae FA Georgina 0237  
 Sitz Dash 10277  
 Mill Brae FA Queen 8035  
 H A Image Maker 0415  
 Mill Brae IF Karama 7083

**ACT BW**  
88  
**ADJ WW RATIO**  
809 / 112  
**ADJ YW RATIO**  
1380 / 109

CED	BW	WW	YW	SC	DOC	MILK	DAM BR										
9	1.3	80	144	1.54	26	37	5@97										
CW	MARB	RE	\$M	\$W	\$B	\$C	DAM WR										
68	0.71	0.41	81	81	158	286	5@110										
CED	BW	WW	YW	DMI	YH	SC	DOC	HP	CEM	MLK	MW	MH	CW	MRB	RE	FAT	TEND
43	62	6	5	98	11	6	21	9	48	7	18	10	5	29	75	58	15

- **Dam's Calving Interval:** 368 days
- **Recommended for cows.** Larger framed performance bull back to a cow that doesn't miss.

## LOT 14 CATTLEMENS CUT SALE



**J TRADEMARK 3077**

# 13 J Trademark 3126

REG: 20769226 DOB: 01/27/23 TATTOO: 3126



Sitz Resilient 10208  
**J Trademark 1037**  
 Mill Brae Iden Georgina 4086  
 Hoffman Accelerate 5169  
**J Lady 8064**  
 R T P Atlas Lady 127

Sitz Stellar 726D  
 Sitz Miss Burgess 1856  
 Koupals B&B Identity  
 Mill Brae FA Georgina 0237  
 Rathbun Accelerate Z523  
 JM Ms Final Answer 9058  
 R T P Bismarck Atlas 9551  
 R T P Frontier Lady 527

**ACT BW**  
81  
**ADJ WW RATIO**  
700 / 97  
**ADJ YW RATIO**  
/

CED	BW	WW	YW	SC	DOC	MILK	DAM BR										
12	-0.7	64	117	0.78	15	30	4@91										
CW	MARB	RE	\$M	\$W	\$B	\$C	DAM WR										
53	0.93	0.49	73	70	162	283	4@96										
CED	BW	WW	YW	DMI	YH	SC	DOC	HP	CEM	MLK	MW	MH	CW	MRB	RE	FAT	TEND
70	68	4	3	95	2	42	57	31	53	17	11	4	2	23	13	74	30

- **Dam's Calving Interval:** 367 days
- **Recommended for heifers or cows.** Moderate framed but excellent pattern and shape.

# 14 J Trademark 3077

REG: 20769175 DOB: 01/20/23 TATTOO: 3077



Sitz Resilient 10208  
**J Trademark 1037**  
 Mill Brae Iden Georgina 4086  
 J Accelerate 8001  
**J Patricia's Pride 0123**  
 J J D Patricia's Pride 1204

Sitz Stellar 726D  
 Sitz Miss Burgess 1856  
 Koupals B&B Identity  
 Mill Brae FA Georgina 0237  
 Hoffman Accelerate 5169  
 J Blackie Avala 6023  
 Cherry Crk Daybreak 973  
 J J D Patricia's Pride 0096

**ACT BW**  
88  
**ADJ WW RATIO**  
805 / 112  
**ADJ YW RATIO**  
1357 / 106

CED	BW	WW	YW	SC	DOC	MILK	DAM BR										
9	2.0	84	149	0.53	20	25	2@105										
CW	MARB	RE	\$M	\$W	\$B	\$C	DAM WR										
74	0.66	0.73	66	73	175	293	2@113										
CED	BW	WW	YW	DMI	YH	SC	DOC	HP	CEM	MLK	MW	MH	CW	MRB	RE	FAT	TEND
46	88	1	1	95	1	69	44	19	10	47	1	1	1	49	7	15	17

- **Dam's Calving Interval:** 375 days
- **Recommended for cows.** Maternal brother to a high seller last year. This young dam is just getting started. Larger framed growth bull.

**LOT 16 CATTLEMENS CUT SALE**



**J TRADEMARK 3069**

**15 J Trademark 3078**

REG: 20761860 DOB: 01/20/23 TATTOO: 3078



Sitz Resilient 10208  
**J Trademark 1037**  
 Mill Brae Iden Georgina 4086  
 Connealy Spur  
**J Lady 0131**  
 Lady Hans Product 6037

Sitz Stellar 726D  
 Sitz Miss Burgess 1856  
 Koupals B&B Identity  
 Mill Brae FA Georgina 0237  
 Connealy Stimulus 8419  
 Jazza of Conanga 8594  
 Connealy Final Product  
 Lady Hans Pioneer 4031

**ACT BW**  
72  
**ADJ WW RATIO**  
700 / 97  
**ADJ YW RATIO**  
1247 / 98

CED	BW	WW	YW	SC	DOC	MILK	DAM BR										
15	-1.7	72	131	-0.23	21	38	2@92										
CW	MARB	RE	\$M	\$W	\$B	\$C	DAM WR										
54	0.55	0.69	89	82	139	269	2@99										
CED	BW	WW	YW	DMI	YH	SC	DOC	HP	CEM	MLK	MW	MH	CW	MRB	RE	FAT	TEND
6	22	20	13	85	78	97	34	5	31	7	35	66	15	52	27	87	4

- **Dam's Calving Interval:** 373 days
- **Recommended for heifers or cows.** Great calving ease bull back to a fertile Spur daughter.

**16 J Trademark 3069**

REG: 20769235 DOB: 01/19/23 TATTOO: 3069



Sitz Resilient 10208  
**J Trademark 1037**  
 Mill Brae Iden Georgina 4086  
 S A V Pioneer 7301  
**Bear Mtn Judy 3092**  
 Bear Mtn Judy 0133

Sitz Stellar 726D  
 Sitz Miss Burgess 1856  
 Koupals B&B Identity  
 Mill Brae FA Georgina 0237  
 S A V Final Answer 0035  
 S A V Blackbird 5297  
 Garret's Nationwide 8001  
 Bear Mtn Judy 6184

**ACT BW**  
91  
**ADJ WW RATIO**  
737 / 102  
**ADJ YW RATIO**  
1295 / 102

CED	BW	WW	YW	SC	DOC	MILK	DAM BR										
5	2.2	70	117	0.60	16	32	9@107										
CW	MARB	RE	\$M	\$W	\$B	\$C	DAM WR										
50	0.44	0.42	73	74	130	242	9@102										
CED	BW	WW	YW	DMI	YH	SC	DOC	HP	CEM	MLK	MW	MH	CW	MRB	RE	FAT	TEND
73	81	17	39	46	12	66	49	58	40	20	46	17	17	63	43	26	5

- **Dam's Calving Interval:** 362 days
- **Recommended for cows.** Out of the dam of Bear Mountain Justify, a stout featured heavy muscled bull.

*special thanks to* **TY BASS**



No one gets to the finish line alone, and we wouldn't get here without the help of our friend, Ty Bass. Not only does he help us out with the bull sale preparation, but also late night calving, and just about anything you can imagine around the ranch. He always answers our calls for help, and goes above and beyond. He works extremely hard at his own operation and somehow uses the remainder of his time and energy helping us. We're forever thankful and don't know what we would do without his help and his friendship – Thanks, Ty!

*sons of*  
**Mill Brae Iden  
 Georgina 4086**  
*sell as*  
**Lots 17-21**



**THE DAM OF TRADEMARK**

*flush brothers* **LOTS 17-18** *The last full sibs to J Trademark. Great in their type and kind. The full sisters are looking great with their first calf.*



Sire of Lots 17-18 **Sitz Resilient 10208**



**J RESILIENT 3136**

**17 J Resilient 3131 ET**

REG: 20761960 DOB: 01/27/23 TATTOO: 3131



Sitz Stellar 726D  
**Sitz Resilient 10208**  
 Sitz Miss Burgess 1856  
 Koupals B&B Identity  
**Mill Brae Iden Georgina 4086**  
 Mill Brae FA Georgina 0237

Mohnen Substantial 272  
 SITZ Pride 200B  
 Sitz Top Game 561X  
 Sitz Miss Burgess 4381  
 Sitz Upward 307R  
 B&B Erica 605  
 S A V Final Answer 0035  
 Mill Brae 878 Georgina 2156

**ACT BW**  
 81  
**ADJ WW RATIO**  
 745 / 110  
**ADJ YW RATIO**  
 1315 / 107

CED	BW	WW	YW	SC	DOC	MILK	DAM BR										
10	-0.2	80	132	0.83	7	29	7@99										
CW	MARB	RE	\$M	\$W	\$B	\$C	DAM WR										
59	0.98	0.55	88	84	164	301	7@103										
CED	BW	WW	YW	DMI	YH	SC	DOC	HP	CEM	MLK	MW	MH	CW	MRB	RE	FAT	TEND
68	74	6	37	58	11	29	86	12	65	52	44	31	9	10	38	75	27

- Dam's Calving Interval: ET
- Recommended for heifers or cows.

**18 J Resilient 3136 ET**

REG: 20811401 DOB: 01/27/23 TATTOO: 3136



Sitz Stellar 726D  
**Sitz Resilient 10208**  
 Sitz Miss Burgess 1856  
 Koupals B&B Identity  
**Mill Brae Iden Georgina 4086**  
 Mill Brae FA Georgina 0237

Mohnen Substantial 272  
 SITZ Pride 200B  
 Sitz Top Game 561X  
 Sitz Miss Burgess 4381  
 Sitz Upward 307R  
 B&B Erica 605  
 S A V Final Answer 0035  
 Mill Brae 878 Georgina 2156

**ACT BW**  
 75  
**ADJ WW RATIO**  
 747 / 110  
**ADJ YW RATIO**  
 1293 / 103

CED	BW	WW	YW	SC	DOC	MILK	DAM BR										
10	-0.4	85	145	0.85	20	26	7@99										
CW	MARB	RE	\$M	\$W	\$B	\$C	DAM WR										
71	0.85	0.93	98	86	180	331	7@103										
CED	BW	WW	YW	DMI	YH	SC	DOC	HP	CEM	MLK	MW	MH	CW	MRB	RE	FAT	TEND
28	38	3	11	91	6	34	26	6	78	61	30	10	3	21	3	52	7

- Dam's Calving Interval: ET
- Recommended for heifers or cows.

# Fair-n-square sons

## reference sire



### Myers Fair-N-Square M39 19418329

Woodhill Blueprint X Myers Miss Beauty M136

by Connealy Thunder

CED	BW	WW	YW	SC	DOC	MILK
3	2.2	74	126	0.54	23	21
CW	MARB	RE	\$M	\$W	\$B	\$C
53	0.92	0.70	72	64	168	290

## flush brothers LOTS 19-21

Exciting set of flush brothers here. Out of Trademark's dam, these Fair n Square brothers are built right from the ground up. Stout and square with added look.

### 19 J Fair-N-Square 3157 ET

REG: 20769292 DOB: 01/30/23 TATTOO: 3157



Woodhill Blueprint  
Myers Fair-N-Square M39  
Myers Miss Beauty M136  
Koupals B&B Identity  
Mill Brae Iden Georgina 4086  
Mill Brae FA Georgina 0237

Connealy Confidence Plus  
Woodhill Evergreen Z291-B233  
Connealy Thunder  
Myers Miss Beauty M476  
Sitz Upward 307R  
B&B Erica 605  
S A V Final Answer 0035  
Mill Brae 878 Georgina 2156

ACT BW	71
ADJ WW RATIO	802 / 100
ADJ YW RATIO	1362 / 100
DAM BR	7@99
DAM WR	7@103

CED	BW	WW	YW	SC	DOC	MILK											
10	0.1	78	141	0.53	24	27											
CW	MARB	RE	\$M	\$W	\$B	\$C											
72	1.18	0.66	69	76	202	331											
CED	BW	WW	YW	DMI	YH	SC	DOC	HP	CEM	MLK	MW	MH	CW	MRB	RE	FAT	TEND
26	35	11	11	79	63	52	39	65	19	57	22	36	4	3	44	94	4

- Dam's Calving Interval: ET
- Recommended for heifers or cows.

### LOT 19 CATTLEMENS CUT SALE



J FAIR-N-SQUARE 3157

### 20 J Fair-N-Square 3169 ET

REG: 20769290 DOB: 02/01/23 TATTOO: 3169



Woodhill Blueprint  
Myers Fair-N-Square M39  
Myers Miss Beauty M136  
Koupals B&B Identity  
Mill Brae Iden Georgina 4086  
Mill Brae FA Georgina 0237

Connealy Confidence Plus  
Woodhill Evergreen Z291-B233  
Connealy Thunder  
Myers Miss Beauty M476  
Sitz Upward 307R  
B&B Erica 605  
S A V Final Answer 0035  
Mill Brae 878 Georgina 2156

ACT BW	85
ADJ WW RATIO	764 / 113
ADJ YW RATIO	1297 / 106
DAM BR	7@99
DAM WR	7@103

CED	BW	WW	YW	SC	DOC	MILK											
4	1.7	77	135	0.09	28	27											
CW	MARB	RE	\$M	\$W	\$B	\$C											
69	0.76	0.69	69	72	172	292											
CED	BW	WW	YW	DMI	YH	SC	DOC	HP	CEM	MLK	MW	MH	CW	MRB	RE	FAT	TEND
45	39	10	18	86	21	80	17	81	34	23	16	7	4	42	40	90	18

- Dam's Calving Interval: ET
- Recommended for cows.

### 21 J Fair-N-Square 3160 ET

REG: 20769288 DOB: 01/30/23 TATTOO: 3160



Woodhill Blueprint  
Myers Fair-N-Square M39  
Myers Miss Beauty M136  
Koupals B&B Identity  
Mill Brae Iden Georgina 4086  
Mill Brae FA Georgina 0237

Connealy Confidence Plus  
Woodhill Evergreen Z291-B233  
Connealy Thunder  
Myers Miss Beauty M476  
Sitz Upward 307R  
B&B Erica 605  
S A V Final Answer 0035  
Mill Brae 878 Georgina 2156

ACT BW	84
ADJ WW RATIO	799 / 118
ADJ YW RATIO	1372 / 112
DAM BR	7@99
DAM WR	7@103

CED	BW	WW	YW	SC	DOC	MILK											
6	1.2	81	145	0.57	26	24											
CW	MARB	RE	\$M	\$W	\$B	\$C											
68	1.06	0.69	69	72	189	314											
CED	BW	WW	YW	DMI	YH	SC	DOC	HP	CEM	MLK	MW	MH	CW	MRB	RE	FAT	TEND
60	77	3	2	96	14	32	23	56	44	59	3	3	3	11	26	40	14

- Dam's Calving Interval: ET
- Recommended for cows.



LOT 23 CATTLEMENS CUT SALE



J FAIR-N-SQUARE 3155

## 22 J Fair-N-Square 3195

REG: 20763408 DOB: 02/05/23 TATTOO: 3195



Woodhill Blueprint  
**Myers Fair-N-Square M39**  
 Myers Miss Beauty M136  
 Sitz Resilient 10208  
**J Joanie 1116 ET**  
 Mill Brae Wis Joanie 4152

Connealy Confidence Plus  
 Woodhill Evergreen Z291-B233  
 Connealy Thunder  
 Myers Miss Beauty M476  
 Sitz Stellar 726D  
 Sitz Miss Burgess 1856  
 Sitz Wisdom 481T  
 Mill Brae IF Joanie 9206

<b>ACT BW</b>	75
<b>ADJ WW RATIO</b>	767 / 107
<b>ADJ YW RATIO</b>	1329 / 104

CED	BW	WW	YW	SC	DOC	MILK	DAM BR										
4	1.2	90	158	1.55	20	27	1@94										
CW	MARB	RE	\$M	\$W	\$B	\$C	DAM WR										
82	0.98	0.72	67	82	199	325	1@107										
CED	BW	WW	YW	DMI	YH	SC	DOC	HP	CEM	MLK	MW	MH	CW	MRB	RE	FAT	TEND
55	53	1	2	99	11	5	56	16	58	58	2	6	1	16	28	62	47

- **Dam's Calving Interval:** First Calf Heifer
- **Recommended for cows.** Easy to find performance bull out of a first calf heifer.

## 23 J Fair-N-Square 3155

REG: 20763433 DOB: 01/30/23 TATTOO: 3155



Woodhill Blueprint  
**Myers Fair-N-Square M39**  
 Myers Miss Beauty M136  
 S S Niagara Z29  
**J Emma 0041**  
 Bartels Emma Time 0002 7031

Connealy Confidence Plus  
 Woodhill Evergreen Z291-B233  
 Connealy Thunder  
 Myers Miss Beauty M476  
 Hoover Dam  
 Jet S S X144  
 Connealy Onward  
 Bartels Emma Time 0002 6537

<b>ACT BW</b>	88
<b>ADJ WW RATIO</b>	754 / 105
<b>ADJ YW RATIO</b>	1338 / 104

CED	BW	WW	YW	SC	DOC	MILK	DAM BR										
3	3.3	86	153	0.44	19	17	2@100										
CW	MARB	RE	\$M	\$W	\$B	\$C	DAM WR										
68	0.74	1.01	60	64	172	283	2@95										
CED	BW	WW	YW	DMI	YH	SC	DOC	HP	CEM	MLK	MW	MH	CW	MRB	RE	FAT	TEND
69	85	1	2	100	12	68	56	56	54	92	2	2	2	31	5	50	58

- **Dam's Calving Interval:** 356 days
- **Recommended for cows.** Stout featured, long sided and a phenotypic standout. Backed by a great cow.

## 24 J Fair-N-Square 3186

REG: 20763406 DOB: 02/04/23 TATTOO: 3186



Woodhill Blueprint  
**Myers Fair-N-Square M39**  
 Myers Miss Beauty M136  
 Sitz Resilient 10208  
**J Georgina 1052**  
 Mill Brae 5151 Georgina 0308

Connealy Confidence Plus  
 Woodhill Evergreen Z291-B233  
 Connealy Thunder  
 Myers Miss Beauty M476  
 Sitz Stellar 726D  
 Sitz Miss Burgess 1856  
 Mill Brae 338 RT 5151  
 Mill Brae 878 Georgina 2156

<b>ACT BW</b>	81
<b>ADJ WW RATIO</b>	728 / 101
<b>ADJ YW RATIO</b>	1283 / 101

CED	BW	WW	YW	SC	DOC	MILK	DAM BR										
3	1.1	68	117	0.75	21	29	1@101										
CW	MARB	RE	\$M	\$W	\$B	\$C	DAM WR										
38	0.85	0.51	94	75	136	270	1@101										
CED	BW	WW	YW	DMI	YH	SC	DOC	HP	CEM	MLK	MW	MH	CW	MRB	RE	FAT	TEND
61	41	47	59	66	86	40	54	31	49	40	89	88	76	17	75	87	81

- **Dam's Calving Interval:** First Calf Heifer
- **Recommended for cows.** Longevity built into the pedigree here, his granddam still in production at 14.

## 25 J Fair-N-Square 3081

REG: 20769284 DOB: 01/21/23 TATTOO: 3081



Woodhill Blueprint  
**Myers Fair-N-Square M39**  
 Myers Miss Beauty M136  
 Connealy Black Granite  
**Gmar Black Granite D284**  
 Gmar Resource B161

Connealy Confidence Plus  
 Woodhill Evergreen Z291-B233  
 Connealy Thunder  
 Myers Miss Beauty M476  
 Connealy Consensus 7229  
 Eura Elga of Conanga 9109  
 S A V Resource 1441  
 Gmar Rito 6243

<b>ACT BW</b>	91
<b>ADJ WW RATIO</b>	682 / 95
<b>ADJ YW RATIO</b>	1260 / 100

CED	BW	WW	YW	SC	DOC	MILK	DAM BR										
9	0.8	71	125	1.02	19	35	6@104										
CW	MARB	RE	\$M	\$W	\$B	\$C	DAM WR										
57	0.56	1.06	64	78	159	270	6@100										
CED	BW	WW	YW	DMI	YH	SC	DOC	HP	CEM	MLK	MW	MH	CW	MRB	RE	FAT	TEND
32	48	23	23	72	20	18	61	70	33	10	49	33	20	56	11	37	78

- **Dam's Calving Interval:** 364 days
- **Recommended for cows.** Larger framed performance bull with added length.



# 26 J Fair-N-Square 3038

REG: 20769277 DOB: 01/13/23 TATTOO: 3038



Woodhill Blueprint  
**Myers Fair-N-Square M39**  
 Myers Miss Beauty M136  
 S A V Angus Valley 1867  
**Mill Brae AV Joanie 6023**  
 Mill Brae HD Joanie 4039

Connealy Confidence Plus  
 Woodhill Evergreen Z291-B233  
 Connealy Thunder  
 Myers Miss Beauty M476  
 S A V Iron Mountain 8066  
 S A V May 2397  
 Hoover Dam  
 Mill Brae Bis Joanie 2249

**ACT BW**  
83  
**ADJ WW RATIO**  
782 / 109  
**ADJ YW RATIO**  
1347 / 105

CED	BW	WW	YW	SC	DOC	MILK	DAM BR										
7	0.6	77	129	0.63	17	26	6@95										
CW	MARB	RE	\$M	\$W	\$B	\$C	DAM WR										
43	0.85	0.54	52	72	137	230	6@108										
CED	BW	WW	YW	DMI	YH	SC	DOC	HP	CEM	MLK	MW	MH	CW	MRB	RE	FAT	TEND
42	26	3	34	93	7	27	69	55	56	40	4	9	34	20	68	85	87

- **Dam's Calving Interval:** 362 days
- **Recommended for heifers or cows.** Added muscle shape and dimension in this larger framed Recommended for heifers or cows.

## LOT 26 CATTLEMENS CUT SALE



J FAIR-N-SQUARE 3038

# 27 J Fair-N-Square 3005

REG: 20764457 DOB: 01/08/23 TATTOO: 3005



Woodhill Blueprint  
**Myers Fair-N-Square M39**  
 Myers Miss Beauty M136  
 Sitz Investment 660Z  
**J Lady Erica 9144 ET**  
 SandPoint Lady Erica 3032

Connealy Confidence Plus  
 Woodhill Evergreen Z291-B233  
 Connealy Thunder  
 Myers Miss Beauty M476  
 Connealy Final Product  
 Sitz Ellunas Elite 656T  
 Connealy Consensus 7229  
 SandPoint Lady Erica 0622

**ACT BW**  
72  
**ADJ WW RATIO**  
698 / 97  
**ADJ YW RATIO**  
1277 / 101

CED	BW	WW	YW	SC	DOC	MILK	DAM BR										
12	-0.7	69	122	0.80	20	28	3@97										
CW	MARB	RE	\$M	\$W	\$B	\$C	DAM WR										
47	0.68	0.35	54	70	133	227	3@98										
CED	BW	WW	YW	DMI	YH	SC	DOC	HP	CEM	MLK	MW	MH	CW	MRB	RE	FAT	TEND
7	15	23	36	88	54	28	60	54	39	33	27	23	41	29	91	100	72

- **Dam's Calving Interval:** 344 days
- **Recommended for heifers or cows.** Smooth made and long sided. Calving ease bull out of a picture perfect young cow.

# 28 J Fair-N-Square 3124

REG: 20769222 DOB: 01/27/23 TATTOO: 3124



Woodhill Blueprint  
**Myers Fair-N-Square M39**  
 Myers Miss Beauty M136  
 K C F Bennett Fortress  
**J Ellunamere 9033 ET**  
 Poss Ellunamere 5507

Connealy Confidence Plus  
 Woodhill Evergreen Z291-B233  
 Connealy Thunder  
 Myers Miss Beauty M476  
 Connealy Consensus  
 Thomas Patricia 9705  
 Poss Easy Impact 0119  
 Poss Ellunamere 119

**ACT BW**  
79  
**ADJ WW RATIO**  
661 / 92  
**ADJ YW RATIO**  
1215 / 96

CED	BW	WW	YW	SC	DOC	MILK	DAM BR										
10	0.9	73	123	0.08	19	19	2@99										
CW	MARB	RE	\$M	\$W	\$B	\$C	DAM WR										
37	1.12	0.64	56	68	153	254	2@102										
CED	BW	WW	YW	DMI	YH	SC	DOC	HP	CEM	MLK	MW	MH	CW	MRB	RE	FAT	TEND
16	37	13	50	83	86	72	65	88	82	88	37	74	58	8	50	79	78

- **Dam's Calving Interval:** 361 days
- **Recommended for heifers or cows.** Moderated framed bull full of red meat, calving ease without sacrificing growth and muscle.

# 29 J Fair-N-Square 3205

REG: 20769300 DOB: 02/08/23 TATTOO: 3205



Woodhill Blueprint  
**Myers Fair-N-Square M39**  
 Myers Miss Beauty M136  
 Koupals B&B Identity  
**Mill Brae Ident Joanie 4024**  
 Mill Brae IF Joanie 2086

Connealy Confidence Plus  
 Woodhill Evergreen Z291-B233  
 Connealy Thunder  
 Myers Miss Beauty M476  
 Sitz Upward 307R  
 B&B Erica 605  
 Mytty In Focus  
 Mill Brae 1407 Joanie 5139

**ACT BW**  
77  
**ADJ WW RATIO**  
771 / 107  
**ADJ YW RATIO**  
1350 / 107

CED	BW	WW	YW	SC	DOC	MILK	DAM BR										
8	0.4	65	119	1.30	18	30	8@94										
CW	MARB	RE	\$M	\$W	\$B	\$C	DAM WR										
56	0.98	0.72	63	66	182	299	8@111										
CED	BW	WW	YW	DMI	YH	SC	DOC	HP	CEM	MLK	MW	MH	CW	MRB	RE	FAT	TEND
47	54	21	32	50	62	12	60	60	24	35	29	27	15	11	28	49	88

- **Dam's Calving Interval:** 365 days
- **Recommended for heifers or cows.** We've been waiting for 4024 to have a bull since we brought her home from Maple Hill. And when she did, he doesn't disappoint. Excellent calving ease bull.

## LOT 29 CATTLEMENS CUT SALE



J FAIR-N-SQUARE 3205

# LOT 31 CATTLEMENS CUT SALE



**J FAIR-N-SQUARE 3044**

## 30 J Fair-N-Square 3115

REG: 20769279 DOB: 01/25/23 TATTOO: 3115



Woodhill Blueprint  
**Myers Fair-N-Square M39**  
 Myers Miss Beauty M136  
 Musgrave Big Sky  
**J Blackie Avala 6023**  
 JMc Blackie Avala 0319 4807

Connealy Confidence Plus  
 Woodhill Evergreen Z291-B233  
 Connealy Thunder  
 Myers Miss Beauty M476  
 Connealy Earnan 076E  
 SAV Primrose 7861  
 Connealy Onward  
 Blackie of Conanga 285 985

<b>ACT BW</b>	87
<b>ADJ WW RATIO</b>	638 / 89
<b>ADJ YW RATIO</b>	1211 / 96
<b>DAM BR</b>	5@98
<b>DAM WR</b>	5@94

CED	BW	WW	YW	SC	DOC	MILK	DAM BR										
7	2.7	70	119	1.50	27	24	5@98										
CW	MARB	RE	\$M	\$W	\$B	\$C	DAM WR										
58	0.84	0.62	60	62	167	277	5@94										
CED	BW	WW	YW	DMI	YH	SC	DOC	HP	CEM	MLK	MW	MH	CW	MRB	RE	FAT	TEND
71	90	9	40	66	21	9	10	81	85	45	18	18	6	30	36	77	68

- **Dam's Calving Interval:** 369 days
- **Recommended for cows.** Back to Big Sky daughter, pedigree to make mama cows.

## 31 J Fair-N-Square 3044

REG: 20763400 DOB: 01/14/23 TATTOO: 3044



Woodhill Blueprint  
**Myers Fair-N-Square M39**  
 Myers Miss Beauty M136  
 Hoover No Doubt  
**J Ellunamere 1057 ET**  
 Poss Ellunamere 5507

Connealy Confidence Plus  
 Woodhill Evergreen Z291-B233  
 Connealy Thunder  
 Myers Miss Beauty M476  
 Mogck Bullseye  
 Miss Blackcap Ellston J2  
 Poss Easy Impact 0119  
 Poss Ellunamere 119

<b>ACT BW</b>	81
<b>ADJ WW RATIO</b>	722 / 100
<b>ADJ YW RATIO</b>	1244 / 98
<b>DAM BR</b>	1@101
<b>DAM WR</b>	1@100

CED	BW	WW	YW	SC	DOC	MILK	DAM BR										
6	2.8	78	138	1.52	28	18	1@101										
CW	MARB	RE	\$M	\$W	\$B	\$C	DAM WR										
65	0.72	0.70	62	58	169	281	1@100										
CED	BW	WW	YW	DMI	YH	SC	DOC	HP	CEM	MLK	MW	MH	CW	MRB	RE	FAT	TEND
41	73	10	11	94	54	5	21	29	7	84	8	18	10	27	47	85	55

- **Dam's Calving Interval:** First Calf Heifer
- **Recommended for heifers or cows.** Our first no doubt daughters calf crop and they did exactly what we hoped. This calf is phenotypically hard to fault and square made from the ground up.

# 32 J Fair-N-Square 3094

REG: 20763416 DOB: 01/23/23 TATTOO: 3094



Woodhill Blueprint  
**Myers Fair-N-Square M39**  
 Myers Miss Beauty M136  
 Sitz Resilient 10208  
**J Erica 1012**  
 J Erica 9060

Connealy Confidence Plus  
 Woodhill Evergreen Z291-B233  
 Connealy Thunder  
 Myers Miss Beauty M476  
 Sitz Stellar 726D  
 Sitz Miss Burgess 1856  
 Connealy Ruger  
 Bear Mtn Erica 3342

**ACT BW**  
76  
**ADJ WW RATIO**  
703 / 98  
**ADJ YW RATIO**  
1175 / 93

CED	BW	WW	YW	SC	DOC	MILK	DAM BR										
12	-0.6	69	118	1.09	21	32	1@95										
CW	MARB	RE	\$M	\$W	\$B	\$C	DAM WR										
48	0.72	0.76	95	80	151	291	1@98										
CED	BW	WW	YW	DMI	YH	SC	DOC	HP	CEM	MLK	MW	MH	CW	MRB	RE	FAT	TEND
22	31	18	37	61	70	14	36	5	87	19	52	72	27	42	24	70	61

- **Dam's Calving Interval:** First Calf Heifer
- **Recommended for cows.** Moderate framed calving ease bull that has a pedigree loaded with maternal merit.



# 33 J Fair-N-Square 3030

REG: 20763401 DOB: 01/12/23 TATTOO: 3030



Woodhill Blueprint  
**Myers Fair-N-Square M39**  
 Myers Miss Beauty M136  
 Hoover No Doubt  
**J Ellunamere 1045 ET**  
 J Ellunamere 9055 ET

Connealy Confidence Plus  
 Woodhill Evergreen Z291-B233  
 Connealy Thunder  
 Myers Miss Beauty M476  
 Mogck Bullseye  
 Miss Blackcap Ellston J2  
 K C F Bennett Fortress  
 Poss Ellunamere 5507

**ACT BW**  
77  
**ADJ WW RATIO**  
747 / 104  
**ADJ YW RATIO**  
1336 / 106

CED	BW	WW	YW	SC	DOC	MILK	DAM BR										
2	1.6	89	156	0.43	24	22	1@97										
CW	MARB	RE	\$M	\$W	\$B	\$C	DAM WR										
76	0.86	0.62	47	74	185	287	1@104										
CED	BW	WW	YW	DMI	YH	SC	DOC	HP	CEM	MLK	MW	MH	CW	MRB	RE	FAT	TEND
63	35	5	9	86	48	66	52	77	26	70	6	20	8	10	53	99	74

- **Dam's Calving Interval:** First Calf Heifer
- **Recommended for cows.** A growth bull that offers great phenotype with added end product merit.



LOT 33 CATTLEMENS CUT SALE

J FAIR-N-SQUARE 3030

# 34 J Fair-N-Square 3071

REG: 20769268 DOB: 01/19/23 TATTOO: 3071



Woodhill Blueprint  
**Myers Fair-N-Square M39**  
 Myers Miss Beauty M136  
 CTS Remedy 1T01  
**Mill Brae Rem Queen 7227**  
 Mill Brae Obj Queen 8021

Connealy Confidence Plus  
 Woodhill Evergreen Z291-B233  
 Connealy Thunder  
 Myers Miss Beauty M476  
 Connealy Thunder  
 CTS 7V03 Bellemere Maid 9T02  
 S S Objective T510 OT26  
 Mill Brae NL Queen 6024

**ACT BW**  
94  
**ADJ WW RATIO**  
744 / 103  
**ADJ YW RATIO**  
1414 / 110

CED	BW	WW	YW	SC	DOC	MILK	DAM BR										
-6	5.1	97	173	0.48	30	31	5@104										
CW	MARB	RE	\$M	\$W	\$B	\$C	DAM WR										
75	0.99	0.65	48	77	186	289	5@95										
CED	BW	WW	YW	DMI	YH	SC	DOC	HP	CEM	MLK	MW	MH	CW	MRB	RE	FAT	TEND
100	100	1	1	97	9	47	8	76	70	21	2	2	1	14	53	56	65

- **Dam's Calving Interval:** 366 days
- **Recommended for cows.** Larger framed performance bull with added bone and muscle. Hard to fault.



# overdrive sons

## reference sire



### Bullerman Overdrive 1013 20096500

4M Ace 709 X Bullerman Blackbird 9105

by Bullerman Unlimited

CED	BW	WW	YW	SC	DOC	MILK
0	3.8	76	144	0.59	9	21
CW	MARB	RE	\$M	\$W	\$B	\$C
69	0.09	0.91	62	55	157	266

### LOT 35 CATTLEMENS CUT SALE



### J OVERDRIVE 3225

## 35 J Overdrive 3225

REG: 20805536 DOB: 02/17/23 TATTOO: 3225



4M Ace 709  
**Bullerman Overdrive 1013**  
 Bullerman Blackbird 9105  
 S A V Downpour 8794  
**J Karen 0130**  
 T K Karen B356

Musgrave Aviator  
 KGM Enchantress 4054  
 Bullerman Unlimited  
 Bullerman Blackbird 1442  
 S A V Rainfall 6846  
 S A V Madame Pride 4407  
 S A V Paramount 0115  
 T K Karen W617

ACT BW
85
ADJ WW RATIO
773 / 107
ADJ YW RATIO
/

CED	BW	WW	YW	SC	DOC	MILK	DAM BR										
4	2.6	75	147	0.20	18	25	2@99										
CW	MARB	RE	\$M	\$W	\$B	\$C	DAM WR										
64	0.26	0.83	46	61	144	233	2@101										
CED	BW	WW	YW	DMI	YH	SC	DOC	HP	CEM	MLK	MW	MH	CW	MRB	RE	FAT	TEND
55	66	24	2	95	28	85	28	71	49	54	18	19	18	89	18	31	34

- **Dam's Calving Interval:** 379 days
- **Recommended for cows.** A really unique Overdrive son here. Extremely good in his type and kind and built wide from the ground up. His dam is off to a great start. Don't overlook him because he is younger, he will age like a fine wine.

## 36 J Overdrive 3246

REG: 20805552 DOB: 02/26/23 TATTOO: 3246



4M Ace 709  
**Bullerman Overdrive 1013**  
 Bullerman Blackbird 9105  
 S S Niagara Z29  
**J Bell 0158**  
 Gmar Confidence D806

Musgrave Aviator  
 KGM Enchantress 4054  
 Bullerman Unlimited  
 Bullerman Blackbird 1442  
 Hoover Dam  
 Jet S S X144  
 MM Confidence J2132  
 Gmar Significant B437

ACT BW
85
ADJ WW RATIO
727 / 101
ADJ YW RATIO
/

CED	BW	WW	YW	SC	DOC	MILK	DAM BR										
0	3.2	74	135	0.39	11	22	2@99										
CW	MARB	RE	\$M	\$W	\$B	\$C	DAM WR										
58	0.50	0.96	61	62	157	265	2@102										
CED	BW	WW	YW	DMI	YH	SC	DOC	HP	CEM	MLK	MW	MH	CW	MRB	RE	FAT	TEND
86	78	12	7	86	41	78	75	51	64	75	32	26	27	61	12	10	53

- **Dam's Calving Interval:** 407 days
- **Recommended for cows.** Youngest bull in the sale but in no way short on quality. It would be hard to fault the muscle pattern and dimension in this calf.

# flush brothers LOTS 37-41

We decided to use Overdrive because of the cow power we believed he would add. This flush is out of one of our oldest donors that is absolutely tried and true doing it the right way. These brothers will add longevity and fertility without sacrificing phenotype.

## 37 J Overdrive 3144 ET

REG: 20811387 DOB: 01/28/23 TATTOO: 3144



4M Ace 709  
**Bullerman Overdrive 1013**  
 Bullerman Blackbird 9105  
 Connealy Consensus 7229  
**R T P Consensus Tara 1942**  
 JMc Queen Miya 9421 4510

Musgrave Aviator  
 KGM Enchantress 4054  
 Bullerman Unlimited  
 Bullerman Blackbird 1442  
 Connealy Consensus  
 Blue Lilly of Conanga 16  
 S A V Final Answer 0035  
 JMc Queen Mina 4510 3282

<b>ACT BW</b>	91
<b>ADJ WW RATIO</b>	710 / 105
<b>ADJ YW RATIO</b>	1320 / 105

CED	BW	WW	YW	SC	DOC	MILK	DAM BR										
2	3.1	63	121	0.58	20	23	6@102										
CW	MARB	RE	\$M	\$W	\$B	\$C	DAM WR										
61	0.57	0.50	60	50	165	274	7@104										
CED	BW	WW	YW	DMI	YH	SC	DOC	HP	CEM	MLK	MW	MH	CW	MRB	RE	FAT	TEND
90	89	22	4	77	22	57	23	14	72	65	9	14	6	50	51	51	15

- Dam's Calving Interval: ET
- Recommended for cows.

### LOT 37 CATTLEMENS CUT SALE



J OVERDRIVE 3144

## 38 J Overdrive 3172 ET

REG: 20811398 DOB: 02/01/23 TATTOO: 3172



4M Ace 709  
**Bullerman Overdrive 1013**  
 Bullerman Blackbird 9105  
 Connealy Consensus 7229  
**R T P Consensus Tara 1942**  
 JMc Queen Miya 9421 4510

Musgrave Aviator  
 KGM Enchantress 4054  
 Bullerman Unlimited  
 Bullerman Blackbird 1442  
 Connealy Consensus  
 Blue Lilly of Conanga 16  
 S A V Final Answer 0035  
 JMc Queen Mina 4510 3282

<b>ACT BW</b>	85
<b>ADJ WW RATIO</b>	673 / 99
<b>ADJ YW RATIO</b>	1217 / 99

CED	BW	WW	YW	SC	DOC	MILK	DAM BR										
4	1.9	47	90	0.91	10	25	6@102										
CW	MARB	RE	\$M	\$W	\$B	\$C	DAM WR										
39	0.16	0.52	77	47	117	229	7@104										
CED	BW	WW	YW	DMI	YH	SC	DOC	HP	CEM	MLK	MW	MH	CW	MRB	RE	FAT	TEND
83	80	48	30	55	39	35	78	9	64	74	58	35	28	90	60	60	3

- Dam's Calving Interval: ET
- Recommended for cows.

## 39 J Overdrive 3168 ET

REG: 20811388 DOB: 02/01/23 TATTOO: 3168



4M Ace 709  
**Bullerman Overdrive 1013**  
 Bullerman Blackbird 9105  
 Connealy Consensus 7229  
**R T P Consensus Tara 1942**  
 JMc Queen Miya 9421 4510

Musgrave Aviator  
 KGM Enchantress 4054  
 Bullerman Unlimited  
 Bullerman Blackbird 1442  
 Connealy Consensus  
 Blue Lilly of Conanga 16  
 S A V Final Answer 0035  
 JMc Queen Mina 4510 3282

<b>ACT BW</b>	84
<b>ADJ WW RATIO</b>	649 / 96
<b>ADJ YW RATIO</b>	1177 / 96

CED	BW	WW	YW	SC	DOC	MILK	DAM BR										
5	1.7	53	101	0.89	13	26	6@102										
CW	MARB	RE	\$M	\$W	\$B	\$C	DAM WR										
46	0.35	0.58	68	47	138	247	7@104										
CED	BW	WW	YW	DMI	YH	SC	DOC	HP	CEM	MLK	MW	MH	CW	MRB	RE	FAT	TEND
90	89	22	4	77	22	57	23	14	72	65	9	14	6	50	51	51	15

- Dam's Calving Interval: ET
- Recommended for cows.

## 40 J Overdrive 3185 ET

REG: 20811385 DOB: 02/04/23 TATTOO: 3185



4M Ace 709  
**Bullerman Overdrive 1013**  
 Bullerman Blackbird 9105  
 Connealy Consensus 7229  
**R T P Consensus Tara 1942**  
 JMc Queen Miya 9421 4510

Musgrave Aviator  
 KGM Enchantress 4054  
 Bullerman Unlimited  
 Bullerman Blackbird 1442  
 Connealy Consensus  
 Blue Lilly of Conanga 16  
 S A V Final Answer 0035  
 JMc Queen Mina 4510 3282

<b>ACT BW</b>	89
<b>ADJ WW RATIO</b>	703 / 104
<b>ADJ YW RATIO</b>	1277 / 102

CED	BW	WW	YW	SC	DOC	MILK	DAM BR										
5	3.1	66	125	1.42	17	22	6@102										
CW	MARB	RE	\$M	\$W	\$B	\$C	DAM WR										
49	0.22	0.67	53	52	128	219	7@104										
CED	BW	WW	YW	DMI	YH	SC	DOC	HP	CEM	MLK	MW	MH	CW	MRB	RE	FAT	TEND
72	87	14	5	74	23	12	47	28	93	72	15	29	20	90	41	59	19

- Dam's Calving Interval: ET
- Recommended for cows.

## 41 J Overdrive 3187 ET

REG: 20811384 DOB: 02/05/23 TATTOO: 3187



4M Ace 709  
**Bullerman Overdrive 1013**  
 Bullerman Blackbird 9105  
 Connealy Consensus 7229  
**R T P Consensus Tara 1942**  
 JMc Queen Miya 9421 4510

Musgrave Aviator  
 KGM Enchantress 4054  
 Bullerman Unlimited  
 Bullerman Blackbird 1442  
 Connealy Consensus  
 Blue Lilly of Conanga 16  
 S A V Final Answer 0035  
 JMc Queen Mina 4510 3282

<b>ACT BW</b>	90
<b>ADJ WW RATIO</b>	765 / 113
<b>ADJ YW RATIO</b>	1298 / 106

CED	BW	WW	YW	SC	DOC	MILK	DAM BR										
-1	3.8	61	113	1.09	17	24	6@102										
CW	MARB	RE	\$M	\$W	\$B	\$C	DAM WR										
61	0.43	0.51	73	50	152	270	7@104										
CED	BW	WW	YW	DMI	YH	SC	DOC	HP	CEM	MLK	MW	MH	CW	MRB	RE	FAT	TEND
93	94	28	11	83	22	17	32	1	69	65	29	26	10	79	66	95	13

- Dam's Calving Interval: ET
- Recommended for cows.

# revered sons

## reference sire



### LT Revered 19548516

Basin Rainmaker 4404 X LT Ashley 7078

by S Foundation 514

CED	BW	WW	YW	SC	DOC	MILK
10	0.5	67	128	1.51	37	30
CW	MARB	RE	\$M	\$W	\$B	\$C
60	0.84	0.42	81	65	172	304

### LOT 42 CATTLEMENS CUT SALE



J REVERED 3070

### 42 J Revered 3070

REG: 20769188 DOB: 01/19/23 TATTOO: 3070



Basin Rainmaker 4404  
 LT Revered  
 LT Ashley 7078  
 Casino Bomber N33  
 J Blackcap 0082 ET  
 Mill Brae Obj Blackcap 9244

Basin Rainmaker 2704  
 Basin Joy 1036  
 S Foundation 514  
 LT Ashley 8263  
 KM Broken Bow 002  
 Casino Annie K48  
 S S Objective T510 0T26  
 Mill Brae RT Blackcap 8022

ACT BW

89

ADJ WW RATIO

853 / 118

ADJ YW RATIO

1488 / 117



CED	BW	WW	YW	SC	DOC	MILK	DAM BR										
6	1.3	87	154	1.21	22	33	2@103										
CW	MARB	RE	\$M	\$W	\$B	\$C	DAM WR										
88	0.32	0.47	61	80	163	272	2@115										
CED	BW	WW	YW	DMI	YH	SC	DOC	HP	CEM	MLK	MW	MH	CW	MRB	RE	FAT	TEND
24	42	7	98	3	33	22	28	12	11	7	10	3	84	61	79	99	

- **Dam's Calving Interval:** 376 days
- **Recommended for cows.** Big framed, long sided, heavy muscled on great feet. A true performance bull here that traces back to a Mill Brae matriarch in our herd.

### 43 J Revered 3125

REG: 20769195 DOB: 01/27/23 TATTOO: 3125



Basin Rainmaker 4404  
 LT Revered  
 LT Ashley 7078  
 Casino Bomber N33  
 J Tosha 0001  
 GVC Tosha F511

Basin Rainmaker 2704  
 Basin Joy 1036  
 S Foundation 514  
 LT Ashley 8263  
 KM Broken Bow 002  
 Casino Annie K48  
 K C F Bennett Consent Y75  
 GVC Tosha A73

ACT BW

79

ADJ WW RATIO

690 / 96

ADJ YW RATIO

1295 / 102



CED	BW	WW	YW	SC	DOC	MILK	DAM BR										
9	0.5	69	126	1.30	36	24	2@89										
CW	MARB	RE	\$M	\$W	\$B	\$C	DAM WR										
56	0.65	0.76	80	63	160	288	2@99										
CED	BW	WW	YW	DMI	YH	SC	DOC	HP	CEM	MLK	MW	MH	CW	MRB	RE	FAT	TEND
46	62	20	11	75	24	22	1	2	53	54	26	51	9	54	16	75	80

- **Dam's Calving Interval:** 380 days
- **Recommended for cows.** Calving ease bull with added shape and dimension back to a front pasture cow.

### 44 J Revered 3063

REG: 20764452 DOB: 01/18/23 TATTOO: 3063



Basin Rainmaker 4404  
 LT Revered  
 LT Ashley 7078  
 T/D Midwest 8330  
 J Blackcap 1062  
 MillBrae Ident Blackcap 6135

Basin Rainmaker 2704  
 Basin Joy 1036  
 S Foundation 514  
 LT Ashley 8263  
 B/R Nationwide 69  
 B/R Ruby of Tiffany 3210  
 Koupals B&B Identity  
 Mill Brae FL Blackcap 5002

ACT BW

77

ADJ WW RATIO

716 / 99

ADJ YW RATIO

1338 / 104



CED	BW	WW	YW	SC	DOC	MILK	DAM BR										
10	0.0	63	117	1.09	27	34	1@97										
CW	MARB	RE	\$M	\$W	\$B	\$C	DAM WR										
47	0.81	0.42	80	68	142	264	1@99										
CED	BW	WW	YW	DMI	YH	SC	DOC	HP	CEM	MLK	MW	MH	CW	MRB	RE	FAT	TEND
21	18	35	25	85	14	37	6	45	16	13	30	16	28	41	66	88	18

- **Dam's Calving Interval:** First Calf Heifer
- **Recommended for heifers or cows.** Very smooth in his make up this calving ease bull has a pedigree loaded for cow production.

# 45 J Reversed 3058

REG: 20764427 DOB: 01/16/23 TATTOO: 3058



Basin Rainmaker 4404  
**LT Reversed**  
 LT Ashley 7078  
 Hoover No Doubt  
**J Ellunamere 1046 ET**  
 J Ellunamere 9055 ET

Basin Rainmaker 2704  
 Basin Joy 1036  
 S Foundation 514  
 LT Ashley 8263  
 Mogck Bullseye  
 Miss Blackcap Ellston J2  
 K C F Bennett Fortress  
 Poss Ellunamere 5507

**ACT BW**  
77  
**ADJ WW RATIO**  
753 / 105  
**ADJ YW RATIO**  
1297 / 103

CED	BW	WW	YW	SC	DOC	MILK	DAM BR										
10	0.3	73	130	0.13	30	18	1@97										
CW	MARB	RE	\$M	\$W	\$B	\$C	DAM WR										
44	0.83	0.42	59	63	140	241	1@105										
CED	BW	WW	YW	DMI	YH	SC	DOC	HP	CEM	MLK	MW	MH	CW	MRB	RE	FAT	TEND
12	12	34	29	80	66	86	7	71	42	91	53	55	56	41	77	87	64

- **Dam's Calving Interval:** First Calf Heifer
- **Recommended for heifers or cows.** Excellent phenotype on this calving ease spread bull. Big middled extended through his front third and plenty of muscle shape.

## LOT 45 CATTLEMENS CUT SALE



J REVERED 3058

# 46 J Reversed 3098

REG: 20769191 DOB: 01/23/23 TATTOO: 3098



Basin Rainmaker 4404  
**LT Reversed**  
 LT Ashley 7078  
 J Accelerate 8001  
**J Ruby of Tiffany 0109**  
 B/R Ruby of Tiffany 393

Basin Rainmaker 2704  
 Basin Joy 1036  
 S Foundation 514  
 LT Ashley 8263  
 Hoffman Accelerate 5169  
 J Blackie Avala 6023  
 BDAR Game On X047  
 B/R Ruby of Tiffany 8496

**ACT BW**  
82  
**ADJ WW RATIO**  
689 / 96  
**ADJ YW RATIO**  
1262 / 100

CED	BW	WW	YW	SC	DOC	MILK	DAM BR										
13	0.5	58	117	0.72	20	30	2@97										
CW	MARB	RE	\$M	\$W	\$B	\$C	DAM WR										
52	0.76	0.60	61	57	152	258	2@102										
CED	BW	WW	YW	DMI	YH	SC	DOC	HP	CEM	MLK	MW	MH	CW	MRB	RE	FAT	TEND
32	71	46	6	89	15	59	32	34	77	10	40	47	38	16	72	100	25

- **Dam's Calving Interval:** 375 days
- **Recommended for heifers or cows.** Extremely complete in his make up. Long sided and square hipped out of a great young cow.

# 47 J Reversed 3007

REG: 20769219 DOB: 01/09/23 TATTOO: 3007



Basin Rainmaker 4404  
**LT Reversed**  
 LT Ashley 7078  
 T/D Midwest 8330  
**J Donna 1153**  
 HF Donna 7435

Basin Rainmaker 2704  
 Basin Joy 1036  
 S Foundation 514  
 LT Ashley 8263  
 B/R Nationwide 69  
 B/R Ruby of Tiffany 3210  
 S A V Prosperity 9131  
 Lawsons Donna A435

**ACT BW**  
91  
**ADJ WW RATIO**  
817 / 113  
**ADJ YW RATIO**  
1372 / 106

CED	BW	WW	YW	SC	DOC	MILK	DAM BR										
10	0.4	63	108	1.24	33	17	1@113										
CW	MARB	RE	\$M	\$W	\$B	\$C	DAM WR										
54	0.50	0.49	84	59	143	269	1@113										
CED	BW	WW	YW	DMI	YH	SC	DOC	HP	CEM	MLK	MW	MH	CW	MRB	RE	FAT	TEND
4	3	69	72	28	89	20	2	61	40	93	81	88	40	59	82	93	52

- **Dam's Calving Interval:** First Calf Heifer
- **Recommended for heifers or cows.** Moderated framed calving ease bull with added length. Shaped for calving ease without sacrificing pounds.

# 48 J Reversed 3097

REG: 20769208 DOB: 01/23/23 TATTOO: 3097



Basin Rainmaker 4404  
**LT Reversed**  
 LT Ashley 7078  
 K C F Bennett Consent Y75  
**GVC Erica F512**  
 GVC Erica A74

Basin Rainmaker 2704  
 Basin Joy 1036  
 S Foundation 514  
 LT Ashley 8263  
 Connealy Consensus  
 K C F Miss Protege W148  
 MCATL Pilgrim 520-495  
 GVC Erica Y21

**ACT BW**  
88  
**ADJ WW RATIO**  
777 / 108  
**ADJ YW RATIO**  
1355 / 107

CED	BW	WW	YW	SC	DOC	MILK	DAM BR										
5	1.3	71	123	0.61	36	33	4@105										
CW	MARB	RE	\$M	\$W	\$B	\$C	DAM WR										
47	1.10	0.26	58	74	151	254	4@109										
CED	BW	WW	YW	DMI	YH	SC	DOC	HP	CEM	MLK	MW	MH	CW	MRB	RE	FAT	TEND
74	67	9	8	95	9	66	1	83	95	10	14	27	22	8	96	99	30

- **Dam's Calving Interval:** 365 days
- **Recommended for cows.** Extremely clean made through his shoulder and neck. We are excited about the Reversed females and he will make the right kind.

## LOT 48 CATTLEMENS CUT SALE



J REVERED 3097

# 49 J Reversed 3091

REG: 20769206 DOB: 01/22/23 TATTOO: 3091



Basin Rainmaker 4404  
 LT Reversed  
 | LT Ashley 7078  
 Hoffman Accelerate 5169  
 J Gloria 9102  
 | J Gloria 7039

Basin Rainmaker 2704  
 Basin Joy 1036  
 S Foundation 514  
 LT Ashley 8263  
 Rathbun Accelerate Z523  
 JM Ms Final Answer 9058  
 H Cash 4081 Et  
 JM Ms Chisum 6175 2179

ACT BW	84
ADJ WW RATIO	686 / 95
ADJ YW RATIO	1244 / 98
HDSOK	

CED	BW	WW	YW	SC	DOC	MILK	DAM BR										
7	0.6	59	110	1.21	30	23	3@93										
CW	MARB	RE	\$M	\$W	\$B	\$C	DAM WR										
41	0.67	0.17	65	53	129	232	3@96										
CED	BW	WW	YW	DMI	YH	SC	DOC	HP	CEM	MLK	MW	MH	CW	MRB	RE	FAT	TEND
60	55	18	9	91	15	18	2	23	11	59	10	29	19	31	91	98	27

- **Dam's Calving Interval:** 373 days
- **Recommended for cows.** Smooth patterned with added length and shape. Built like a rancher bull.

# 50 J Reversed 3085

REG: 20769209 DOB: 01/21/23 TATTOO: 3085



Basin Rainmaker 4404  
 LT Reversed  
 | LT Ashley 7078  
 Text Demand 2791  
 J Barbara K 7031  
 | JM Ms Bando 9052 2217

Basin Rainmaker 2704  
 Basin Joy 1036  
 S Foundation 514  
 LT Ashley 8263  
 Rito 9M25 of Rita 5F56 Pred  
 Empress of Holiday 7004  
 FCR Bando 9074 9052  
 JM MS Easy Rockin Bob 8024

ACT BW	94
ADJ WW RATIO	709 / 98
ADJ YW RATIO	1224 / 96
HDSOK	

CED	BW	WW	YW	SC	DOC	MILK	DAM BR										
2	2.1	67	125	1.50	23	24	4@103										
CW	MARB	RE	\$M	\$W	\$B	\$C	DAM WR										
50	1.02	0.37	50	58	165	264	4@97										
CED	BW	WW	YW	DMI	YH	SC	DOC	HP	CEM	MLK	MW	MH	CW	MRB	RE	FAT	TEND
29	26	35	32	68	20	25	21	74	23	67	47	49	47	4	81	64	78

- **Dam's Calving Interval:** 485 days
- **Recommended for cows.** Slightly cold when he joined the world, but with the cow behind him the daughters will bring the heat.

## LOT 51 CATTLEMENS CUT SALE



J REVERED 3017

# 51 J Reversed 3017

REG: 20764449 DOB: 01/11/23 TATTOO: 3017



Basin Rainmaker 4404  
 LT Reversed  
 | LT Ashley 7078  
 Sitz Resilient 10208  
 J Pamela 1018  
 | J Pamela 9146

Basin Rainmaker 2704  
 Basin Joy 1036  
 S Foundation 514  
 LT Ashley 8263  
 Sitz Stellar 726D  
 Sitz Miss Burgess 1856  
 Connealy Spur  
 D/O Pamela 3025

ACT BW	74
ADJ WW RATIO	745 / 103
ADJ YW RATIO	1327 / 103
HDSOK	

CED	BW	WW	YW	SC	DOC	MILK	DAM BR										
11	1.1	78	140	1.27	26	28	1@93										
CW	MARB	RE	\$M	\$W	\$B	\$C	DAM WR										
61	0.69	0.44	83	74	158	288	1@103										
CED	BW	WW	YW	DMI	YH	SC	DOC	HP	CEM	MLK	MW	MH	CW	MRB	RE	FAT	TEND
6	29	7	4	89	14	17	10	63	31	30	12	30	7	44	61	61	22

- **Dam's Calving Interval:** First Calf Heifer
- **Recommended for heifers or cows.** Moderate framed long sided bull in great feet and legs. Out of a productive first calf heifer.

# 52 J Reversed 3045

REG: 20769193 DOB: 01/14/23 TATTOO: 3045



Basin Rainmaker 4404  
 LT Reversed  
 | LT Ashley 7078  
 Casino Bomber N33  
 J Lady Eraline 0055  
 | Bear Mtn Lady Eraline 3029

Basin Rainmaker 2704  
 Basin Joy 1036  
 S Foundation 514  
 LT Ashley 8263  
 KM Broken Bow 002  
 Casino Annie K48  
 GDAR Game Day 449  
 Bear Mtn Lady Eraline 1038

ACT BW	76
ADJ WW RATIO	671 / 93
ADJ YW RATIO	1253 / 97
HDSOK	

CED	BW	WW	YW	SC	DOC	MILK	DAM BR										
8	0.1	69	117	0.61	22	28	2@89										
CW	MARB	RE	\$M	\$W	\$B	\$C	DAM WR										
54	0.81	0.49	85	73	152	282	2@100										
CED	BW	WW	YW	DMI	YH	SC	DOC	HP	CEM	MLK	MW	MH	CW	MRB	RE	FAT	TEND
43	36	37	60	70	55	64	16	55	29	37	85	82	33	26	53	66	77

- **Dam's Calving Interval:** 367 days
- **Recommended for heifers or cows.** Smooth made heifer bull from a very fertile young dam. Will make daughters.

# 53 J Reversed 3035

REG: 20764447 DOB: 01/13/23 TATTOO: 3035



Basin Rainmaker 4404  
 LT Reversed  
 | LT Ashley 7078  
 Sitz Resilient 10208  
 J Lady Hans 1016  
 | J Lady Hans 9040

Basin Rainmaker 2704  
 Basin Joy 1036  
 S Foundation 514  
 LT Ashley 8263  
 Sitz Stellar 726D  
 Sitz Miss Burgess 1856  
 Basin Payweight 107S  
 Lady Hans Lim Edition 2163

ACT BW	77
ADJ WW RATIO	728 / 101
ADJ YW RATIO	1248 / 99
HDSOK	

CED	BW	WW	YW	SC	DOC	MILK	DAM BR										
9	0.7	70	130	0.40	24	27	1@97										
CW	MARB	RE	\$M	\$W	\$B	\$C	DAM WR										
58	0.47	0.37	73	65	141	256	1@101										
CED	BW	WW	YW	DMI	YH	SC	DOC	HP	CEM	MLK	MW	MH	CW	MRB	RE	FAT	TEND
25	30	26	5	81	18	64	17	38	29	45	10	20	14	59	70	94	45

- **Dam's Calving Interval:** First Calf Heifer
- **Recommended for cows.** True calving ease bull in a moderate easy to look at package. The Resilient females are off to a great start.



# panhandle sons

## reference sire

### Marcys Panhandle 214-9 19469944

Marcys 17 Scale Crusher 34-7 X Marcys 12 Ethelda E 64-2

by Connealy Consensus 7229

CED	BW	WW	YW	SC	DOC	MILK
0	3.3	74	136	0.99	25	34
CW	MARB	RE	\$M	\$W	\$B	\$C
64	0.53	0.53	47	64	166	262



### 54 J Panhandle 3047

REG: 20789763 DOB: 01/15/23 TATTOO: 3047



Marcys 17 Scale Crusher 34-7  
**Marcys Panhandle 214-9**  
 Marcys 12 Ethelda E 64-2  
 Connealy Spur  
**J Judy 0051**  
 Bear Mtn Judy 3092

Marcys Scale Crusher  
 Marcys 13 Ethelda E 4-3  
 Connealy Consensus 7229  
 Marcys 10 Ethelda E 165-0  
 Connealy Stimulus 8419  
 Jazza of Conanga 8594  
 S A V Pioneer 7301  
 Bear Mtn Judy 0133

ACT BW
91
ADJ WW RATIO
747 / 104
ADJ YW RATIO
1262 / 100

CED	BW	WW	YW	SC	DOC	MILK	DAM BR										
3	3.0	71	115	0.78	18	27	2@102										
CW	MARB	RE	\$M	\$W	\$B	\$C	DAM WR										
56	0.22	0.34	73	68	119	227	2@107										
CED	BW	WW	YW	DMI	YH	SC	DOC	HP	CEM	MLK	MW	MH	CW	MRB	RE	FAT	TEND
64	63	8	44	76	19	57	59	29	4	15	25	32	10	84	80	94	2

- **Dam's Calving Interval:** 366 days
- **Recommended for cows.** A full brother to a sale feature last year this young dam has hit the ground running. Wide topped, good at the ground. Really complete.

### LOT 54 CATTLEMENS CUT SALE



J PANHANDLE 3047

### 55 J Panhandle 3196

REG: 20789778 DOB: 02/06/23 TATTOO: 3196



Marcys 17 Scale Crusher 34-7  
**Marcys Panhandle 214-9**  
 Marcys 12 Ethelda E 64-2  
 S Whitlock 179  
**J Blackcap 5166**  
 Mill Brae CC Blackcap 5166

Marcys Scale Crusher  
 Marcys 13 Ethelda E 4-3  
 Connealy Consensus 7229  
 Marcys 10 Ethelda E 165-0  
 S Chisum 6175  
 S Pride Anna 709  
 Connealy Consensus 7229  
 Mill Brae Obj Blackcap 8081

ACT BW
88
ADJ WW RATIO
712 / 99
ADJ YW RATIO
1290 / 100

CED	BW	WW	YW	SC	DOC	MILK	DAM BR										
2	1.5	70	130	0.51	20	25	3@101										
CW	MARB	RE	\$M	\$W	\$B	\$C	DAM WR										
49	0.59	0.37	35	62	141	218	3@100										
CED	BW	WW	YW	DMI	YH	SC	DOC	HP	CEM	MLK	MW	MH	CW	MRB	RE	FAT	TEND
37	22	15	16	48	4	70	41	99	51	73	19	9	24	47	76	82	22

- **Dam's Calving Interval:** 369 days
- **Recommended for cows.** Larger framed stretchy Recommended for cows. The panhandle daughters are fertile with great bags, look for him to sire the same.

### 56 J Panhandle 3159

REG: 20789804 DOB: 01/30/23 TATTOO: 3159



Marcys 17 Scale Crusher 34-7  
**Marcys Panhandle 214-9**  
 Marcys 12 Ethelda E 64-2  
 Bear Mtn Owyhee 5012  
**HAVE Forever Lady 5012 1122**  
 HAVE Forever Lady T V P H331

Marcys Scale Crusher  
 Marcys 13 Ethelda E 4-3  
 Connealy Consensus 7229  
 Marcys 10 Ethelda E 165-0  
 Rito 112 of 2536 Rito 616  
 Bear Mtn Barbara 2112  
 Twin Valley Precision E161  
 Three Trees Foreverlady A223

ACT BW
95
ADJ WW RATIO
691 / 96
ADJ YW RATIO
1233 / 96

CED	BW	WW	YW	SC	DOC	MILK	DAM BR										
6	2.9	61	114	0.34	12	30	6@102										
CW	MARB	RE	\$M	\$W	\$B	\$C	DAM WR										
57	0.83	0.46	37	54	169	256	6@94										
CED	BW	WW	YW	DMI	YH	SC	DOC	HP	CEM	MLK	MW	MH	CW	MRB	RE	FAT	TEND
31	38	42	25	69	11	87	74	66	68	15	17	16	21	23	83	60	69

- **Dam's Calving Interval:** 384 days
- **Recommended for cows.** A very complete Panhandle son out of a 13 year old cow that hasn't missed a beat.



J PANHANDLE 3137

# 57 J Panhandle 3137

REG: 20789795 DOB: 01/27/23 TATTOO: 3137



Marcys 17 Scale Crusher 34-7  
**Marcys Panhandle 214-9**  
 Marcys 12 Ethelda E 64-2  
 Bartels Asset 402  
**Orr Judy 7313**  
 Orr Judy 5313

Marcys Scale Crusher  
 Marcys 13 Ethelda E 4-3  
 Connealy Consensus 7229  
 Marcys 10 Ethelda E 165-0  
 Barstow Cash  
 Elsa Plus 868 Bartels 2020  
 Basin Payweight 1682  
 D/O Judy 3132

**ACT BW**  
81  
**ADJ WW RATIO**  
693 / 96  
**ADJ YW RATIO**  
1275 / 101

CED	BW	WW	YW	SC	DOC	MILK	DAM BR										
5	-0.2	58	116	0.83	14	36	5@98										
CW	MARB	RE	\$M	\$W	\$B	\$C	DAM WR										
64	0.77	0.56	41	59	165	255	5@105										
CED	BW	WW	YW	DMI	YH	SC	DOC	HP	CEM	MLK	MW	MH	CW	MRB	RE	FAT	TEND
52	24	27	7	98	15	41	66	45	1	5	7	4	3	27	55	100	3

- **Dam's Calving Interval:** 363 days
- **Recommended for heifers or cows.** Full brother to a sale feature last year. Big topped and big middled with great phenotype. Female maker.

# 58 J Panhandle 3089

REG: 20789800 DOB: 01/22/23 TATTOO: 3089



Marcys 17 Scale Crusher 34-7  
**Marcys Panhandle 214-9**  
 Marcys 12 Ethelda E 64-2  
 Koupals B&B Identity  
**MillBrae Ident Blackcap 6135**  
 Mill Brae FL Blackcap 5002

Marcys Scale Crusher  
 Marcys 13 Ethelda E 4-3  
 Connealy Consensus 7229  
 Marcys 10 Ethelda E 165-0  
 Sitz Upward 307R  
 B&B Erica 605  
 Connealy Freightliner  
 Mill Brae SA Blackcap 3025

**ACT BW**  
91  
**ADJ WW RATIO**  
728 / 101  
**ADJ YW RATIO**  
1226 / 97

CED	BW	WW	YW	SC	DOC	MILK	DAM BR										
4	0.9	57	100	1.19	19	31	6@102										
CW	MARB	RE	\$M	\$W	\$B	\$C	DAM WR										
54	0.73	0.25	82	63	154	282	6@102										
CED	BW	WW	YW	DMI	YH	SC	DOC	HP	CEM	MLK	MW	MH	CW	MRB	RE	FAT	TEND
42	16	45	62	33	13	47	56	17	20	14	64	30	13	43	94	92	2

- **Dam's Calving Interval:** 368 days
- **Recommended for cows.** We can't say enough good things about our Identity cows, electric in production. He will sire ranch cows.

# 59 J Panhandle 3146

REG: 20789797 DOB: 01/29/23 TATTOO: 3146



Marcys 17 Scale Crusher 34-7  
**Marcys Panhandle 214-9**  
 Marcys 12 Ethelda E 64-2  
 S Chisum 455  
**Bear Mtn Lady Eraline 7722**  
 Bear Mtn Lady Eraline 5019

Marcys Scale Crusher  
 Marcys 13 Ethelda E 4-3  
 Connealy Consensus 7229  
 Marcys 10 Ethelda E 165-0  
 S Chisum 255  
 S Jestra 022  
 Sitz Wisdom 481T  
 Bear Mtn Lady Eraline 1038

**ACT BW**  
86  
**ADJ WW RATIO**  
749 / 104  
**ADJ YW RATIO**  
1290 / 100

CED	BW	WW	YW	SC	DOC	MILK	DAM BR										
7	0.6	58	108	-0.23	10	36	5@97										
CW	MARB	RE	\$M	\$W	\$B	\$C	DAM WR										
49	0.70	0.35	61	64	133	234	5@102										
CED	BW	WW	YW	DMI	YH	SC	DOC	HP	CEM	MLK	MW	MH	CW	MRB	RE	FAT	TEND
55	49	18	26	84	2	98	84	12	21	2	23	8	10	34	66	96	33

- **Dam's Calving Interval:** 364 days
- **Recommended for cows.** Extremely well shaped and big topped. His dam is doing it the right way.

# 60 J Panhandle 3139

REG: 20789781 DOB: 01/27/23 TATTOO: 3139



Marcys 17 Scale Crusher 34-7  
**Marcys Panhandle 214-9**  
 Marcys 12 Ethelda E 64-2  
 Hoffman Accelerate 5169  
**J Blackcap 9064**  
 J Blackcap 6006

Marcys Scale Crusher  
 Marcys 13 Ethelda E 4-3  
 Connealy Consensus 7229  
 Marcys 10 Ethelda E 165-0  
 Rathbun Accelerate Z523  
 JM Ms Final Answer 9058  
 V A R Empire 3037  
 Limestone Blackcap W145

**ACT BW**  
94  
**ADJ WW RATIO**  
686 / 95  
**ADJ YW RATIO**  
1192 / 93

CED	BW	WW	YW	SC	DOC	MILK	DAM BR										
1	4.0	72	114	-0.22	24	26	3@104										
CW	MARB	RE	\$M	\$W	\$B	\$C	DAM WR										
47	0.65	0.35	78	63	131	248	3@98										
CED	BW	WW	YW	DMI	YH	SC	DOC	HP	CEM	MLK	MW	MH	CW	MRB	RE	FAT	TEND
80	79	6	41	78	4	91	33	11	37	23	10	7	15	42	89	79	10

- **Dam's Calving Interval:** 371 days
- **Recommended for cows.** A phenotypic standout. Wide topped, big legged and great at the ground.



# 61 J Panhandle 3106

REG: 20789747 DOB: 01/24/23 TATTOO: 3106



Marcys 17 Scale Crusher 34-7  
**Marcys Panhandle 214-9**  
 Marcys 12 Ethelda E 64-2  
 Casino Bomber N33  
**J Georgina 0023**  
 Mill Brae TOD Georgina 6178

Marcys Scale Crusher  
 Marcys 13 Ethelda E 4-3  
 Connealy Consensus 7229  
 Marcys 10 Ethelda E 165-0  
 KM Broken Bow 002  
 Casino Annie K48  
 R B Tour Of Duty 177  
 Mill Brae Bis Georgina 1184

<b>ACT BW</b>	82
<b>ADJ WW RATIO</b>	711 / 99
<b>ADJ YW RATIO</b>	1297 / 103
<b>DAM BR</b>	2@92
<b>DAM WR</b>	2@97

CED	BW	WW	YW	SC	DOC	MILK	DAM BR										
8	0.5	67	122	0.77	30	37	2@92										
CW	MARB	RE	\$M	\$W	\$B	\$C	DAM WR										
62	0.49	0.56	66	73	152	263	2@97										
CED	BW	WW	YW	DMI	YH	SC	DOC	HP	CEM	MLK	MW	MH	CW	MRB	RE	FAT	TEND
21	18	27	39	69	16	50	8	40	12	4	42	29	13	74	64	63	45

- **Dam's Calving Interval:** 373 days
- **Recommended for heifers or cows.** Very extended through his neck with a perfect shoulder. Great heifer bull with added look.

## LOT 61 CATTLEMENS CUT SALE



J PANHANDLE 3106

# 62 J Panhandle 3151

REG: 20789765 DOB: 01/29/23 TATTOO: 3151



Marcys 17 Scale Crusher 34-7  
**Marcys Panhandle 214-9**  
 Marcys 12 Ethelda E 64-2  
 S A V Circuit Breaker 7136  
**J Blackcap 0176**  
 T K Blackcap McHenry A356

Marcys Scale Crusher  
 Marcys 13 Ethelda E 4-3  
 Connealy Consensus 7229  
 Marcys 10 Ethelda E 165-0  
 S A V Recharge 3436  
 S A V Madame Pride 3145  
 S A V Prosperity 9131  
 T K Blackcap Mc Henry T653

<b>ACT BW</b>	92
<b>ADJ WW RATIO</b>	703 / 98
<b>ADJ YW RATIO</b>	1297 / 101
<b>DAM BR</b>	2@105
<b>DAM WR</b>	2@102

CED	BW	WW	YW	SC	DOC	MILK	DAM BR										
-1	3.8	67	124	1.26	25	27	2@105										
CW	MARB	RE	\$M	\$W	\$B	\$C	DAM WR										
51	0.72	0.63	61	56	153	259	2@102										
CED	BW	WW	YW	DMI	YH	SC	DOC	HP	CEM	MLK	MW	MH	CW	MRB	RE	FAT	TEND
85	93	10	4	88	5	24	34	39	75	36	11	5	9	38	30	40	4

- **Dam's Calving Interval:** 382 days
- **Recommended for cows.** Hard to fault the consistency of type and kind in this sire group. Long sided with added shape.

# 63 J Panhandle 3059

REG: 20789801 DOB: 01/17/23 TATTOO: 3059



Marcys 17 Scale Crusher 34-7  
**Marcys Panhandle 214-9**  
 Marcys 12 Ethelda E 64-2  
 Koupals B&B Identity  
**MillBrae Ident Georgina 5188**  
 Mill Brae Bis Georgina 1184

Marcys Scale Crusher  
 Marcys 13 Ethelda E 4-3  
 Connealy Consensus 7229  
 Marcys 10 Ethelda E 165-0  
 Sitz Upward 307R  
 B&B Erica 605  
 S A V Bismarck 5682  
 Mill Brae 878 Georgina 2156

<b>ACT BW</b>	86
<b>ADJ WW RATIO</b>	641 / 89
<b>ADJ YW RATIO</b>	1105 / 87
<b>DAM BR</b>	7@98
<b>DAM WR</b>	7@94

CED	BW	WW	YW	SC	DOC	MILK	DAM BR										
3	1.6	62	106	1.45	23	28	7@98										
CW	MARB	RE	\$M	\$W	\$B	\$C	DAM WR										
44	0.68	0.41	80	64	140	262	7@94										
CED	BW	WW	YW	DMI	YH	SC	DOC	HP	CEM	MLK	MW	MH	CW	MRB	RE	FAT	TEND
55	32	59	60	31	20	22	25	11	43	53	43	25	46	78	52	2	

- **Dam's Calving Interval:** 366 days
- **Recommended for cows.** A fault free calf back to an Identity cow that is as easy fleshing as they come.

# 64 J Panhandle 3080

REG: 20789799 DOB: 01/21/23 TATTOO: 3080



Marcys 17 Scale Crusher 34-7  
**Marcys Panhandle 214-9**  
 Marcys 12 Ethelda E 64-2  
 S A V Resource 1441  
**BM Blackbird 711 1225 R**  
 MGMA Blackbird 1225

Marcys Scale Crusher  
 Marcys 13 Ethelda E 4-3  
 Connealy Consensus 7229  
 Marcys 10 Ethelda E 165-0  
 Rito 707 of Ideal 3407 7075  
 S A V Blackcap May 4136  
 Connealy Final Product  
 Riverbend Blackbird 4348

<b>ACT BW</b>	90
<b>ADJ WW RATIO</b>	695 / 97
<b>ADJ YW RATIO</b>	1250 / 99
<b>DAM BR</b>	5@100
<b>DAM WR</b>	5@101

CED	BW	WW	YW	SC	DOC	MILK	DAM BR										
6	1.2	60	109	0.80	22	33	5@100										
CW	MARB	RE	\$M	\$W	\$B	\$C	DAM WR										
52	0.29	0.58	72	66	127	237	5@101										
CED	BW	WW	YW	DMI	YH	SC	DOC	HP	CEM	MLK	MW	MH	CW	MRB	RE	FAT	TEND
5	7	58	62	51	28	48	32	38	22	3	69	59	28	81	63	72	35

- **Dam's Calving Interval:** 364 days
- **Recommended for cows.** Power packed rancher bull out of a very productive moderate cow.

## LOT 64 CATTLEMENS CUT SALE



J PANHANDLE 3080

# 65 J Panhandle 3134

REG: 20789768 DOB: 01/27/23 TATTOO: 3134



Marcys 17 Scale Crusher 34-7  
**Marcys Panhandle 214-9**  
 Marcys 12 Ethelda E 64-2  
 Connealy Spur  
**J Pamela 9146**  
 D/O Pamela 3025

Marcys Scale Crusher  
 Marcys 13 Ethelda E 4-3  
 Connealy Consensus 7229  
 Marcys 10 Ethelda E 165-0  
 Connealy Stimulus 8419  
 Jazza of Conanga 8594  
 W R A Vindicator W2  
 D/O Pam of Plattemere 0025

**ACT BW**  
85  
**ADJ WW RATIO**  
654 / 91  
**ADJ YW RATIO**  
1220 / 96

CED	BW	WW	YW	SC	DOC	MILK	DAM BR										
6	1.7	65	120	1.31	26	26	3@103										
CW	MARB	RE	\$M	\$W	\$B	\$C	DAM WR										
52	1.01	0.33	52	59	165	266	3@92										
CED	BW	WW	YW	DMI	YH	SC	DOC	HP	CEM	MLK	MW	MH	CW	MRB	RE	FAT	TEND
25	22	39	35	69	21	14	16	80	6	40	41	17	41	11	93	88	12

- **Dam's Calving Interval:** 372 days
- **Recommended for cows.** Extremely balanced bull out of a great young spur daughter. Will sire the right kind.

# 66 J Panhandle 3177

REG: 20789777 DOB: 02/03/23 TATTOO: 3177



Marcys 17 Scale Crusher 34-7  
**Marcys Panhandle 214-9**  
 Marcys 12 Ethelda E 64-2  
 LD Capitalist 316  
**J Miss Emulous 9113**  
 POPE Miss Emulous 705E

Marcys Scale Crusher  
 Marcys 13 Ethelda E 4-3  
 Connealy Consensus 7229  
 Marcys 10 Ethelda E 165-0  
 Connealy Capitalist 028  
 LD Dixie Erica 2053  
 C R R Emulous 26 17  
 Hartz Black Lady Lass 493

**ACT BW**  
92  
**ADJ WW RATIO**  
763 / 106  
**ADJ YW RATIO**  
1288 / 102

CED	BW	WW	YW	SC	DOC	MILK	DAM BR										
6	3.2	69	115	0.85	8	29	3@105										
CW	MARB	RE	\$M	\$W	\$B	\$C	DAM WR										
70	0.59	0.83	61	65	171	283	3@102										
CED	BW	WW	YW	DMI	YH	SC	DOC	HP	CEM	MLK	MW	MH	CW	MRB	RE	FAT	TEND
26	58	31	48	66	20	51	93	73	2	25	40	24	9	50	20	40	38

- **Dam's Calving Interval:** 365 days
- **Recommended for cows.** Long sided calf with excellent muscle shape. Very complete in his type and kind.

# 67 J Midwest 3199

REG: 20759228 DOB: 02/06/23 TATTOO: 3199



B/R Nationwide 69  
**T/D Midwest 8330**  
 B/R Ruby of Tiffany 3210  
 Soo Line Motive 9016  
**Gmar Motive D028**  
 Gmar Onward 7002

JVC Cavalry V3326  
 B/R Pride 1551  
 Connealy Impression  
 B/R Ruby of Tiffany 1130  
 HF Kodiak 5R  
 TLA Beauty 5R  
 Connealy Onward  
 G M A R Lady Spade 4039

**ACT BW**  
92  
**ADJ WW RATIO**  
742 / 103  
**ADJ YW RATIO**  
1254 / 99

CED	BW	WW	YW	SC	DOC	MILK	DAM BR										
-2	2.9	60	101	1.24	12	26	5@103										
CW	MARB	RE	\$M	\$W	\$B	\$C	DAM WR										
36	0.63	0.31	52	52	119	206	5@100										
CED	BW	WW	YW	DMI	YH	SC	DOC	HP	CEM	MLK	MW	MH	CW	MRB	RE	FAT	TEND
88	78	12	41	70	40	20	80	20	88	29	4	21	13	43	74	63	26

- **Dam's Calving Interval:** 366 days
- **Recommended for cows.** Moderate framed easy fleshing bull with added muscle and dimension.

# 68 J Midwest 3227

REG: 20759182 DOB: 02/17/23 TATTOO: 3227



B/R Nationwide 69  
**T/D Midwest 8330**  
 B/R Ruby of Tiffany 3210  
 S S Niagara Z29  
**J Georgina 0066**  
 Mill Brae 5151 Georgina 0308

JVC Cavalry V3326  
 B/R Pride 1551  
 Connealy Impression  
 B/R Ruby of Tiffany 1130  
 Hoover Dam  
 Jet S S X144  
 Mill Brae 338 RT 5151  
 Mill Brae 878 Georgina 2156

**ACT BW**  
89  
**ADJ WW RATIO**  
707 / 113  
**ADJ YW RATIO**  
/

CED	BW	WW	YW	SC	DOC	MILK	DAM BR										
2	2.5	78	131	0.64	14	31	2@101										
CW	MARB	RE	\$M	\$W	\$B	\$C	DAM WR										
61	0.81	0.66	50	75	160	258	2@103										
CED	BW	WW	YW	DMI	YH	SC	DOC	HP	CEM	MLK	MW	MH	CW	MRB	RE	FAT	TEND
82	82	8	41	69	45	60	78	93	91	25	19	24	16	36	56	54	18

- **Dam's Calving Interval:** 335 days
- **Recommended for cows.** The Midwest females are calf raisers, excellent young cow behind him will make great daughters.

# 69 J Midwest 3108

REG: 20759118 DOB: 01/25/23 TATTOO: 3108



B/R Nationwide 69  
**T/D Midwest 8330**  
 B/R Ruby of Tiffany 3210  
 Connealy Consensus 7229  
**BM Blackbird 614 414 CC**  
 BM Blackbird 414 114 U2

JVC Cavalry V3326  
 B/R Pride 1551  
 Connealy Impression  
 B/R Ruby of Tiffany 1130  
 Connealy Consensus  
 Blue Lilly of Conanga 16  
 BM Lights Out U2  
 BM Blackbird 114 33R Pro

**ACT BW**  
97  
**ADJ WW RATIO**  
717 / 100  
**ADJ YW RATIO**  
1205 / 95

CED	BW	WW	YW	SC	DOC	MILK	DAM BR										
4	4.4	69	120	1.37	22	20	6@101										
CW	MARB	RE	\$M	\$W	\$B	\$C	DAM WR										
64	0.31	0.45	66	51	141	249	6@104										
CED	BW	WW	YW	DMI	YH	SC	DOC	HP	CEM	MLK	MW	MH	CW	MRB	RE	FAT	TEND
86	98	11	18	93	5	11	33	28	95	69	17	8	5	80	80	68	76

- **Dam's Calving Interval:** 364 days
- **Recommended for cows.** Larger framed longer sided bull with added growth.

# 70 J Midwest 3204

REG: 20759220 DOB: 02/08/23 TATTOO: 3204



B/R Nationwide 69  
**T/D Midwest 8330**  
 B/R Ruby of Tiffany 3210  
 S S Niagara Z29  
**J Erica 0032**  
 GVC Erica F512

JVC Cavalry V3326  
 B/R Pride 1551  
 Connealy Impression  
 B/R Ruby of Tiffany 1130  
 Hoover Dam  
 Jet S S X144  
 K C F Bennett Consent Y75  
 GVC Erica A74

**ACT BW**  
91  
**ADJ WW RATIO**  
755 / 105  
**ADJ YW RATIO**  
1309 / 104

CED	BW	WW	YW	SC	DOC	MILK	DAM BR										
5	2.2	80	130	1.85	27	21	2@105										
CW	MARB	RE	\$M	\$W	\$B	\$C	DAM WR										
71	1.01	0.74	57	69	183	294	2@99										
CED	BW	WW	YW	DMI	YH	SC	DOC	HP	CEM	MLK	MW	MH	CW	MRB	RE	FAT	TEND
65	50	1	18	96	4	3	21	52	89	75	2	4	1	13	15	96	22

- **Dam's Calving Interval:** 333 days
- **Recommended for cows.** Great young cow behind this bull, younger calf but not short on quality.



**PICK OF THE**  
**2023**  
**HEIFERS**

Building our cow herd with females that are made to work in the Sandhills like a commercial rancher is something we take very seriously. We have decided to offer the choice of our replacement heifers this year, this includes all the AI and ET mates to the bull crop. These heifers have not been treated any differently than if we were keeping them ourselves, running out and in breeding shape. They can be viewed anytime and data will be available. We feel this is a unique opportunity to step into the heart of what we believe in and acquire a cornerstone female.

*Thank you for* **10** *years*



# SCENES FROM 2023



Photos by Country Road Photography



*Thank you*  
**FOR YOUR SUPPORT!**



*see you on February 22!*

JASON & KATIE JAGELS  
43500 E North Loup Rd  
Brewster NE 68821

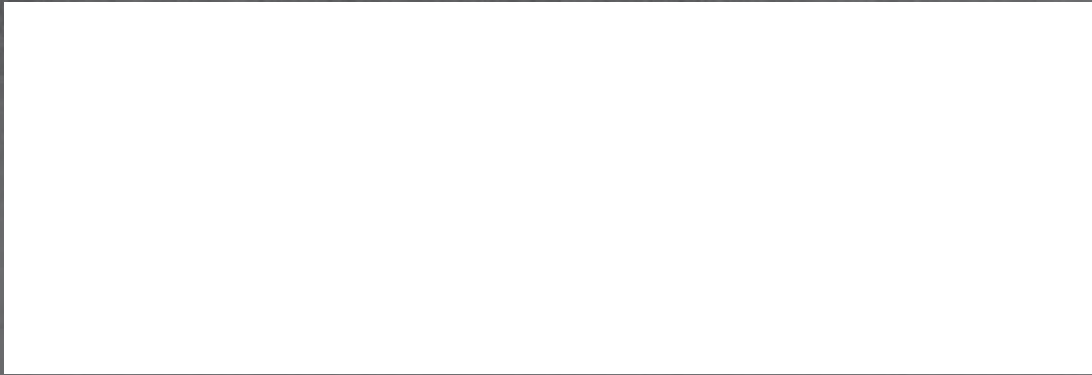

*the*  
**Cattlemen's**  
BREWSTER  
NEBRASKA **CUT**

THURSDAY – 1:00 PM CT

**FEBRUARY 22, 2024**

AT THE RANCH – BREWSTER, NEBRASKA

